

## INDEX

P/N	Page
1B ( BSP MALE 60° SEAT ) .....	5
1B4(45° BSP MALE 60°SEAT).....	7
1B9(90° BSP MALE 60° SEAT).....	8
1B-F(BSP MALE FLAT SEAL).....	9
1BG(BSP MALE 60° SEAT/BSP MALE O-RING).....	10
1BG4-OG(45° BSP MALE 60°SEAT/BSP MALE O-RING).....	11
1BG9-OG (45° BSP MALE 60°SEAT/BSP MALE O-RING).....	12
1BT-SP(BSP MALE 60°SEAT/BSPT MALE).....	13
1BT4-SP (45° BSP MALE 60° SEAT/BSPT MAL).....	15
1BT9-SP (90° BSP MALE 60° SEAT/BSPT MALE).....	16
1BW(BSP MALE 60° SEAT/BUTT-WELD TUBE).....	18
1G ( BSP MALE O - RING ) .....	19
1S(JIS GAS MALE 60° CONE).....	20
1SB(JIS GAS MALE 60° CONE/BSP MALE 60° SEAT).....	21
1SG(JIS GAS MALE 60° CONE/BSP MALE WITH O-RING).....	21
1SG4-OG(45° JIS GAS MALE 60°CONE/BSP MALE WITH O-RING).....	22
1SG9-OG(90° JIS GAS MALE 60°CONE/BSP MALE WITH O-RING).....	23
1ST-SP(JIS GAS MALE 60° CONE/BSPT MALE).....	24
1ST4-SP(45° JIS GAS MALE 60° CONE/BSPT MALE).....	25
1ST9-SP(90° JIS GAS MALE 60° CONE/BSPT MALE).....	26

1T-SP(BSPT MALE).....	27
1T4-SP(45° BSPT MALE).....	28
1T9-SP(90° BSPT MALE).....	29
2B(BSP MALE 60°SEAT/BSP FEMALE 60° CONE).....	30
2B4(45° BSP MALE 60° SEAT/BSP FEMALE 60°CONE).....	31
2B9(90° BSP MALE 60° SEAT/BSP FEMALE 60°CONE).....	32
2BA(BSP MALE 60° SEAT/BSP FEMALE MULTISEAL).....	33
2GB(BSP MALE O-RING/BSP 60° FEMALE).....	34
2GB4-OG(45° BSP MALE O-RING/BSP MALE 60°CONE).....	35
2GB9-OG(90° BSP MALE O-RING/BSP MALE 60° CONE).....	36
2S4(45° JIS GAS MALE/JIS GAS FEMALE).....	37
2S9(90° JIS GAS MALE/JIS GAS FEMALE).....	37
2TA-SP(BSPT MALE/BSP FEMALE MULTISEAL).....	38
2TB-SP(BSPT MALE/BSP FEMALE 60° CONE).....	39
2TB4-SP(45° BSPT MALE/BSP FEMALE 60° CONE).....	40
2TB9-SP(90° BSPT MALE/BSP FEMALE 60° CONE).....	41
2WA(BUTT- WELD TUBE/BSP FEMALE MULTISEAL).....	42
2WB(BUTT-WELD TUBE /BSP FEMALE 60° CONE).....	43
2WB9(90° BUTT-WELD TUBE /BSP FEMALE 60°CONE).....	44
3A(BSP FEMALE MULTISEAL).....	45
3B(BSPP FEMALE 60°CONE).....	46
3B4(45° BSPP FEMALE 60°CONE).....	47

3B9(90° BSPP FEMALE 60° CONE)	48
3BW-S/IN (BSP FEMALE 60° CONE/INCH SOCKET-WELD TUBE)	49
4B(BSP MALE 60° SEAT PLUG)	50
4BN(BSP MALE HOLLOW HEX PLUG)	51
4S(JIS GAS MALE 60° CONE PLUG)	51
4T-SP(BSPT MALE PLUG)	52
5B(BSP MALE 60° SEAT/BSP FEMALE)	53
5B9(90° BSP MALE 60° SEAT/BSP FEMALE)	55
5BT(BSP MALE 60° SEAT/BSPT FEMALE)	56
5BT9(90° BSP MALE 60° SEAT/BSPT FEMALE)	57
5GT(BSP MALE O-RING/BSPT FEMALE)	58
5ST-SP(JIS GAS MALE 60° CONE/BSPT FEMALE)	59
5T-SP(BSPT MALE/BSPT FEMALE)	60
5T9-SP(90° BSPT MALE/BSPT FEMALE)	61
5TB-SP(BSPT MALE/BSP FEMALE)	62
5TB4-SP(45° BSPT MALE/BSP FEMALE)	63
5TB9-SP(90° BSPT MALE/BSP FEMALE)	63
7B(BSP FEMALE)	64
7B4(45° BSP FEMALE)	65
7B9(90° BSP FEMALE)	66
7T(BSPT FEMALE)	67
7T9(90° BSPT FEMALE)	68

7TB-S(BSPT FEMALE/BSP FEMALE 60° CONE).....	69
8B(BSP LOCK NUT).....	70
AB(BSP MALE 60° SEAT).....	71
AT-SP(BSPT MALE).....	72
BB(BSP MALE/BSP FEMALE/BSP MALE).....	73
CB(BSP MALE/BSP MALE/BSP FEMALE).....	74
DB(BSP FEMALE 60° CONE).....	75
EB(BSP FEMALE/BSP MALE/BSP FEMALE).....	76
FB( BSP FEMALE/BSP FEMALE/BSP MALE ).....	77
GB (BSP FEMALE).....	78
GT(BSPT FEMALE).....	79
HT(BSPT FEMALE/BSPT FEMALE/BSPT MALE ).....	80

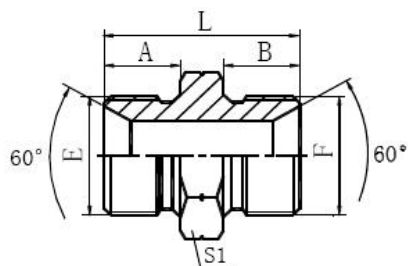

## 1B

英管外螺纹 60°内锥

BSP MALE 60° SEAT

代号 P/N	螺纹 Thread		尺寸 DIMENSIONS			
	E	F	A	B	L	S1
1B-02	G1/8"X28	G1/8"X28	10	10	26	14
1B-02-04	G1/8"X28	G1/4"X19	10	12	28	19
1B-02-06	G1/8"X28	G3/8"X19	10	13.5	31.5	22
1B-02-08	G1/8"X28	G1/2"X14	10	16	36	27
1B-04	G1/4"X19	G1/4"X19	12	12	30	19
1B-04-06	G1/4"X19	G3/8"X19	12	13.5	33.5	22
1B-04-08	G1/4"X19	G1/2"X14	12	16	38	27
1B-04-10	G1/4"X19	G5/8"X14	12	17.5	39.5	30
1B-04-12	G1/4"X19	G3/4"X14	12	18.5	41.5	32
1B-06	G3/8"X19	G3/8"X19	13.5	13.5	35	22
1B-06-08	G3/8"X19	G1/2"X14	13.5	16	39.5	27
1B-06-10	G3/8"X19	G5/8"X14	13.5	17.5	41	30
1B-06-12	G3/8"X19	G3/4"X14	13.5	18.5	43	32
1B-06-16	G3/8"X19	G1"X11	13.5	20.5	47	41
1B-08	G1/2"X14	G1/2"X14	16	16	42	27
1B-08-10	G1/2"X14	G5/8"X14	16	17.5	43.5	30
1B-08-12	G1/2"X14	G3/4"X14	16	18.5	45.5	32
1B-08-16	G1/2"X14	G1"X11	16	20.5	50	41
1B-08-20	G1/2"X14	G1.1/4"X11	16	20.5	53.5	50
1B-10	G5/8"X14	G5/8"X14	17.5	17.5	45	30
1B-10-12	G5/8"X14	G3/4"X14	17.5	18.5	47	32
1B-10-16	G5/8"X14	G1"X11	17.5	20.5	51.5	41

1B-12	G3/4"X14	G3/4"X14	18.5	18.5	48	32
1B-12-16	G3/4"X14	G1"X11	18.5	20.5	52.5	41
1B-12-20	G3/4"X14	G1.1/4"X11	18.5	20.5	56	50
1B-12-24	G3/4"X14	G1.1/2"X11	18.5	23	58.5	55
1B-16	G1"X11	G1"X11	20.5	20.5	55.5	41
1B-16-20	G1"X11	G1.1/4"X11	20.5	20.5	58	50
1B-16-24	G1"X11	G1.1/2"X11	20.5	23	60.5	55
1B-16-32	G1"X11	G2"X11	20.5	25.5	64	70
1B-20	G1.1/4"X11	G1.1/4"X11	20.5	20.5	58	50
1B-20-24	G1.1/4"X11	G1.1/2"X11	20.5	23	60.5	55
1B-20-32	G1.1/4"X11	G2"X11	20.5	25.5	64	70
1B-24	G1.1/2"X11	G1.1/2"X11	23	23	63	55
1B-24-32	G1.1/2"X11	G2"X11	23	25.5	66.5	70
1B-32	G2"X11	G2"X11	25.5	25.5	69	70
1B-40	G2.1/2"X11	G2.1/2"X11	32	32	81	90
1B-48	G3"X11	G3"X11	36	36	92	100

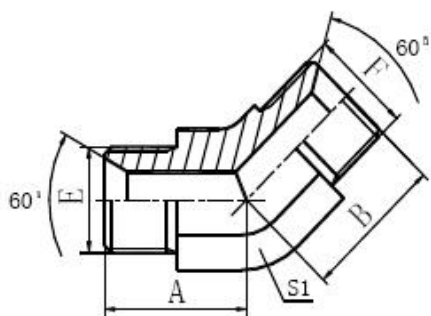

## 1B4

45°英管外螺纹 60°内锥

45° BSP MALE 60°SEAT

代号 P/N	螺纹 Thread		尺寸 DIMENSIONS			
	E	F	A	B	S1	
1B4-02	G1/8"X28	G1/8"X28	17	17	11	
1B4-04	G1/4"X19	G1/4"X19	20.3	20.3	14	
1B4-04-06	G1/4"X19	G3/8"X19	20.5	22	16	
1B4-06	G3/8"X19	G3/8"X19	22	22	16	
1B4-06-08	G3/8"X19	G1/2"X14	24	27	22	
1B4-08	G1/2"X14	G1/2"X14	27	27	22	
1B4-08-12	G1/2"X14	G3/4"X14	28.5	31	27	
1B4-10	G5/8"X14	G5/8"X14	28.5	28.5	22	
1B4-10-12	G5/8"X14	G3/4"X14	30	31	27	
1B4-12	G3/4"X14	G3/4"X14	31	31	27	
1B4-12-16	G3/4"X14	G1"X11	32.5	35	33	
1B4-16	G1"X11	G1"X11	35	35	33	
1B4-16-20	G1"X11	G1.1/4"X11	38.5	38.5	41	
1B4-20	G1.1/4"X11	G1.1/4"X11	38.5	38.5	41	
1B4-20-24	G1.1/4"X11	G1.1/2"X11	41.5	44	48	
1B4-24	G1.1/2"X11	G1.1/2"X11	44	44	48	
1B4-32	G2"X11	G2"X11	51	51	63	

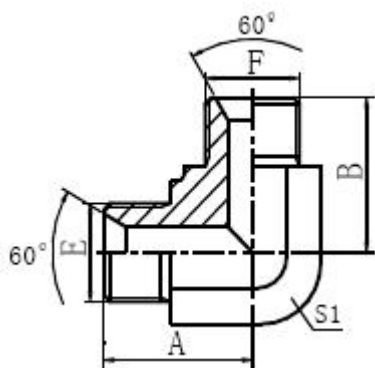

## 1B9

90° 英管外螺纹 60°内锥

90° BSP MALE 60° SEAT

代号 P/N	螺纹 Thread		尺寸 DIMENSIONS			
	E	F	A	B	S1	
1B9-02	G1/8"X28	G1/8"X28	19.8	19.8	11	
1B9-02-04	G1/8"X28	G1/4"X19	23	25	14	
1B9-04	G1/4"X19	G1/4"X19	24.5	24.5	14	
1B9-04-06	G1/4"X19	G3/8"X19	26.5	27.5	16	
1B9-06	G3/8"X19	G3/8"X19	27.5	27.5	16	
1B9-06-08	G3/8"X19	G1/2"X14	31	34.5	22	
1B9-08	G1/2"X14	G1/2"X14	34.5	34.5	22	
1B9-08-12	G1/2"X14	G3/4"X14	37.5	40	27	
1B9-10	G5/8"X14	G5/8"X14	35	35	22	
1B9-10-12	G5/8"X14	G3/4"X14	39	40	27	
1B9-12	G3/4"X14	G3/4"X14	40	40	27	
1B9-12-16	G3/4"X14	G1"X11	43.5	46	33	
1B9-16	G1"X11	G1"X11	46	46	33	
1B9-16-20	G1"X11	G1.1/4"X11	50.5	50.5	41	
1B9-20	G1.1/4"X11	G1.1/4"X11	50.5	50.5	41	
1B9-20-24	G1.1/4"X11	G1.1/2"X11	54.5	57.5	48	
1B9-24	G1.1/2"X11	G1.1/2"X11	57.5	57.5	48	
1B9-32	G2"X11	G2"X11	68	68	63	



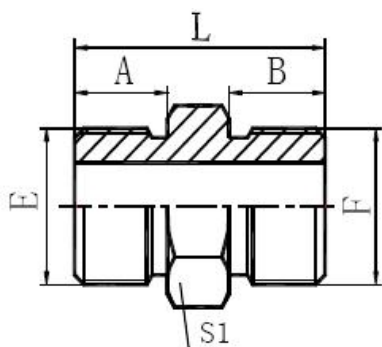

## 1B-F

英管外螺纹端面密封

BSP MALE FLAT SEAL

代号 P/N	螺纹 Thread		尺寸 DIMENSIONS			
	E	F	A	B	L	S1
1B-02F	G1/8"X28	G1/8"X28	9.5	9.5	25	12
1B-04F	G1/4"X19	G1/4"X19	10	10	26	14
1B-06F	G3/8"X19	G3/8"X19	11.5	11.5	29	19
1B-08F	G1/2"X14	G1/2"X14	14	14	36	22
1B-12F	G3/4"X14	G3/4"X14	15.5	15.5	41	30
1B-16F	G1"X11	G1"X11	18	18	47	36
1B-20F	G1.1/4"X11	G1.1/4"X11	20	20	53	46
1B-24F	G1.1/2"X11	G1.1/2"X11	21.5	21.5	58	50
1B-32F	G2"X11	G2"X11	24.5	24.5	66	65

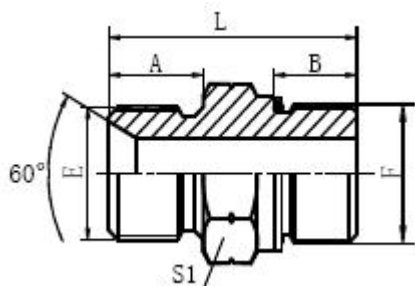

## 1BG

英管外螺纹 60°内锥/英管外螺纹 O 形圈

BSP MALE 60° SEAT/BSP MALE O-RING

代号 P/N	螺纹 Thread		O 形圈 O-RING		尺寸 DIMENSIONS			
	E	F		F END	A	B	L	S1
1BG-02	G1/8"X28	G1/8"X28		7.65X1.78	10	9.5	27	14
1BG-04	G1/4"X19	G1/4"X19		10.77X2.62	12	10	30	19
1BG-04-06	G1/4"X19	G3/8"X19		13.94X2.62	12	11.5	32	22
1BG-06	G3/8"X19	G3/8"X19		13.94X2.62	13.5	11.5	33	22
1BG-06-04	G3/8"X19	G1/4"X19		10.77X2.62	13.5	10	31.5	22
1BG-08	G1/2"X14	G1/2"X14		17.12X2.62	16	14	41	27
1BG-08-12	G1/2"X14	G3/4"X14		23.47X2.62	16	15.5	45.5	32
1BG-10-08	G5/8"X14	G1/2"X14		17.12X2.62	17.5	14	44.5	30
1BG-12	G3/4"X14	G3/4"X14		23.47X2.62	18.5	15.5	46	32
1BG-12-08	G3/4"X14	G1/2"X14		17.12X2.62	18.5	14	45.5	32
1BG-16-08	G1"X11	G1/2"X14		17.12X2.62	20.5	14	50.5	41
1BG-16	G1"X11	G1"X11		29.74X3.53	20.5	18	53	41
1BG-16-12	G1"X11	G3/4"X14		23.47X2.62	20.5	15.5	52	41
1BG-20	G1.1/4"X11	G1.1/4"X11		37.69X3.53	20.5	20	58.5	50
1BG-24	G1.1/2"X11	G1.1/2"X11		44.04X3.53	23	21.5	62.5	55

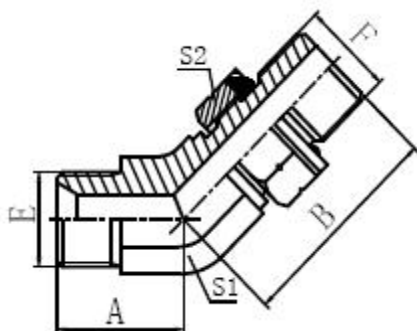

## 1BG4-OG

45°英管外螺纹 60°内锥/英管外螺纹 O 形圈

45° BSP MALE 60°SEAT/BSP MALE O-RING

代号 P/N	螺纹 Thread		O 形圈 O-RING		尺寸 DIMENSIONS			
	E	F		F END	A	B	S1	S2
1BG4-04OG	G1/4"X19	G1/4"X19		10.77X2.62	22	28	14	19
1BG4-04-06OG	G1/4"X19	G3/8"X19		13.94X2.62	21	30	16	22
1BG4-04-08OG	G1/4"X19	G1/2"X14		17.12X2.62	22.5	36	22	27
1BG4-06OG	G3/8"X19	G3/8"X19		13.94X2.62	21	30	16	22
1BG4-06-08OG	G3/8"X19	G1/2"X14		17.12X2.62	23.5	36	22	27
1BG4-08OG	G1/2"X14	G1/2"X14		17.12X2.62	27	36	22	27
1BG4-12OG	G3/4"X14	G3/4"X14		23.47X2.62	32	42	27	32
1BG4-12-16OG	G3/4"X14	G1"X11		29.74X3.53	32.5	44	33	41
1BG4-16OG	G1"X11	G1"X11		29.74X3.53	34	44	33	41
1BG4-20OG	G1.1/4"X11	G1.1/4"X11		37.69X3.53	38.5	47.5	41	50
1BG4-24OG	G1.1/2"X11	G1.1/2"X11		44.04X3.53	44	51.5	48	55

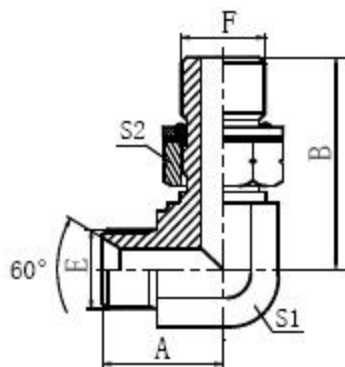

## 1BG9-OG

90°英管外螺纹 60°内锥/英管外螺纹 O 形圈

90°BSP MALE 60° SEAT/BSP MALE O-RING

代号 P/N	螺纹 Thread		O 形圈 O-RING		尺寸 DIMENSIONS			
	E	F		F END	A	B	S1	S2
1BG9-04OG	G1/4"X19	G1/4"X19		10.77X2.62	25	31.8	14	19
1BG9-04-06OG	G1/4"X19	G3/8"X19		13.94X2.62	26.5	36.8	16	22
1BG9-06OG	G3/8"X19	G3/8"X19		13.94X2.62	27.5	36.8	16	22
1BG9-06-02OG	G3/8"X19	G1/8"X28		7.65X1.78	27.5	32	16	14
1BG9-06-08OG	G3/8"X19	G1/2"X14		17.12X2.62	31	43.2	22	27
1BG9-08OG	G1/2"X14	G1/2"X14		17.12X2.62	34.5	43.2	22	27
1BG9-08-12OG	G1/2"X14	G3/4"X14		23.47X2.62	40	49.3	27	32
1BG9-12OG	G3/4"X14	G3/4"X14		23.47X2.62	40	49.3	27	32
1BG9-12-16OG	G3/4"X14	G1"X11		29.74X3.53	45	53	33	41
1BG9-16OG	G1"X11	G1"X11		29.74X3.53	46	53	33	41
1BG9-20-16OG	G1.1/4"X11	G1"X11		29.74X3.53	50.5	58	41	41
1BG9-20OG	G1.1/4"X11	G1.1/4"X11		37.69X3.53	51.5	58	41	50
1BG9-24OG	G1.1/2"X11	G1.1/2"X11		44.04X3.53	58.5	63	48	55

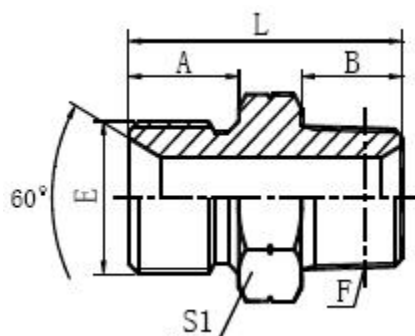

## 1BT-SP

英管外螺纹 60°内锥/英锥管外螺纹

BSP MALE 60°SEAT/BSPT MALE

代号 P/N	螺纹 Thread		尺寸 DIMENSIONS			
	E	F	A	B	L	S1
1BT-02SP	G1/8"X28	R1/8"X28	10	10	26	14
1BT-02-04SP	G1/8"X28	R1/4"X19	10	14.5	30.5	17
1BT-04SP	G1/4"X19	R1/4"X19	12	14.5	32	19
1BT-04-02SP	G1/4"X19	R1/8"X28	12	10	28	19
1BT-04-06SP	G1/4"X19	R3/8"X19	12	15	32	19
1BT-04-08SP	G1/4"X19	R1/2"X14	12	20	40	24
1BT-04-12SP	G1/4"X19	R3/4"X14	12	20	42	32
1BT-06SP	G3/8"X19	R3/8"X19	13.5	15	35.5	22
1BT-06-02SP	G3/8"X19	R1/8"X28	13.5	11	31.5	22
1BT-06-04SP	G3/8"X19	R1/4"X19	13.5	14.5	35.5	22
1BT-06-08SP	G3/8"X19	R1/2"X14	13.5	20	40.5	24
1BT-06-12SP	G3/8"X19	R3/4"X14	13.5	20	42.5	30
1BT-08SP	G1/2"X14	R1/2"X14	16	20	45	27
1BT-08-04SP	G1/2"X14	R1/4"X19	16	14.5	40.5	27
1BT-08-06SP	G1/2"X14	R3/8"X19	16	15	40	27
1BT-08-12SP	G1/2"X14	R3/4"X14	16	20	45	30
1BT-08-16SP	G1/2"X14	R1"X11	16	25.5	52.5	36
1BT-10-06SP	G5/8"X14	R3/8"X19	17.5	15	41.5	30
1BT-10-08SP	G5/8"X14	R1/2"X14	17.5	20	46.5	30
1BT-10-12SP	G5/8"X14	R3/4"X14	17.5	20	46.5	30
1BT-10-16SP	G5/8"X14	R1"X11	17.5	25.5	53	36

NINGBO EASTERN FLUID CONNECTOR MACHINERY FACTORY

1BT-12SP	G3/4"X14	R3/4"X14	18.5	20	48.5	32
1BT-12-04SP	G3/4"X14	R1/4"X19	18.5	15.5	44.5	32
1BT-12-06SP	G3/4"X14	R3/8"X19	18.5	15	43.5	32
1BT-12-08SP	G3/4"X14	R1/2"X14	18.5	20	48.5	32
1BT-12-16SP	G3/4"X14	R1"X11	18.5	25.5	53.5	36
1BT-12-20SP	G3/4"X14	R1.1/4"X11	18.5	26.5	58	46
1BT-12-24SP	G3/4"X14	R1.1/2"X11	18.5	26.5	60	50
1BT-12-32SP	G3/4"X14	R2"X11	18.5	30	65.5	65
1BT-16SP	G1"X11	R1"X11	20.5	25.5	58	41
1BT-16-08SP	G1"X11	R1/2"X14	20.5	20.5	54	41
1BT-16-12SP	G1"X11	R3/4"X14	20.5	20	53	41
1BT-16-20SP	G1"X11	R1.1/4"X11	20.5	26.5	60	46
1BT-16-24SP	G1"X11	R1.1/2"X11	20.5	26.5	62.5	50
1BT-16-32SP	G1"X11	R2"X11	20.5	30	67.5	65
1BT-20SP	G1.1/4"X11	R1.1/4"X11	20.5	26.5	62	50
1BT-20-12SP	G1.1/4"X11	R3/4"X14	20.5	20.5	56	50
1BT-20-16SP	G1.1/4"X11	R1"X11	20.5	25.5	61	50
1BT-20-24SP	G1.1/4"X11	R1.1/2"X11	20.5	26.5	62	50
1BT-20-32SP	G1.1/4"X11	R2"X11	20.5	30	67.5	65
1BT-24SP	G1.1/2"X11	R1.1/2"X11	23	26.5	64.5	55
1BT-24-16SP	G1.1/2"X11	R1"X11	23	25.5	63.5	55
1BT-24-20SP	G1.1/2"X11	R1.1/4"X11	23	26.5	64.5	55
1BT-24-32SP	G1.1/2"X11	R2"X11	23	30	70	65
1BT-32SP	G2"X11	R2"X11	25.5	30	72.5	70
1BT-32-20SP	G2"X11	R1.1/4"X11	25.5	27	68.5	70
1BT-32-24SP	G2"X11	R1.1/2"X11	25.5	26.5	68.5	70
1BT-40SP	G2.1/2"X11	G2.1/2"X11	32	34	83	90
1BT-48SP	G3"X11	R3"X11	36	38	94	100

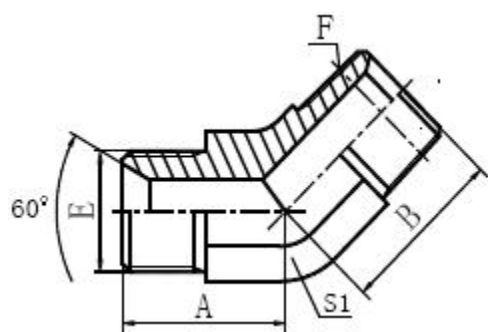

## 1BT4-SP

45°英管外螺纹 60°内锥/英锥管外螺纹

45° BSP MALE 60° SEAT/BSPT MAL

代号 P/N	螺纹 Thread		尺寸 DIMENSIONS			
	E	F	A	B	S1	
1BT4-02SP	G1/8"X28	R1/8"X28	17	17	11	
1BT4-04SP	G1/4"X19	R1/4"X19	20.3	21	14	
1BT4-04-06SP	G1/4"X19	R3/8"X19	20.5	23	16	
1BT4-06SP	G3/8"X19	R3/8"X19	22	23	16	
1BT4-06-04SP	G3/8"X19	R1/4"X19	22	21	16	
1BT4-06-08SP	G3/8"X19	R1/2"X14	24	29.5	22	
1BT4-06-12SP	G3/8"X19	R3/4"X14	25.5	30.5	27	
1BT4-08SP	G1/2"X14	R1/2"X14	27	29.5	22	
1BT4-08-06SP	G1/2"X14	R3/8"X19	27	25	22	
1BT4-08-12SP	G1/2"X14	R3/4"X14	28.5	30.5	27	
1BT4-10-08SP	G5/8"X14	R1/2"X14	28.5	29.5	22	
1BT4-10-12SP	G5/8"X14	R3/4"X14	30	30.5	27	
1BT4-12SP	G3/4"X14	R3/4"X14	31	30.5	27	
1BT4-12-08SP	G3/4"X14	R1/2"X14	31	30.5	27	
1BT4-12-16SP	G3/4"X14	R1"X11	32.5	38	33	
1BT4-16SP	G1"X11	R1"X11	35	38	33	
1BT4-16-12SP	G1"X11	R3/4"X14	35	32.5	33	
1BT4-16-20SP	G1"X11	R1.1/4"X11	38.5	43	41	
1BT4-20SP	G1.1/4"X11	R1.1/4"X11	38.5	43	41	
1BT4-20-16SP	G1.1/4"X11	R1"X11	38.5	42	41	
1BT4-20-24SP	G1.1/4"X11	R1.1/2"X11	41.5	47.5	48	
1BT4-24SP	G1.1/2"X11	R1.1/2"X11	44	47.5	48	

1BT4-24-20SP	G1.1/2"X11	R1.1/4"X11	44	45.5	48	
1BT4-24-32SP	G1.1/2"X11	R2"X11	48	53	63	
1BT4-32SP	G2"X11	R2"X11	48	53	63	
1BT4-32-24SP	G2"X11	R1.1/2"X11	51	52	63	

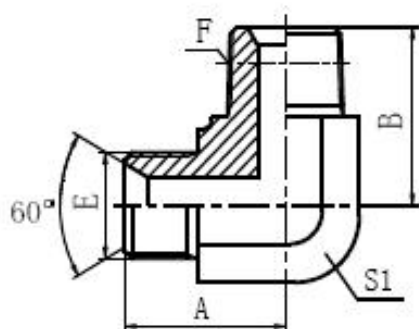

## 1BT9-SP

90°英管外螺纹 60°内锥/英锥管外螺纹

90° BSP MALE 60° SEAT/BSPT MALE

代号 P/N	螺纹 Thread		尺寸 DIMENSIONS			
	E	F	A	B	S1	
1BT9-02SP	G1/8"X28	R1/8"X28	19.8	21	11	
1BT9-02-04SP	G1/8"X28	R1/4"X19	22.3	25.5	14	
1BT9-04SP	G1/4"X19	R1/4"X19	24.5	25.5	14	
1BT9-04-02SP	G1/4"X19	R1/8"X28	25	23.5	14	
1BT9-04-06SP	G1/4"X19	R3/8"X19	25	28.5	16	
1BT9-04-08SP	G1/4"X19	R1/2"X14	30	36	22	
1BT9-06SP	G3/8"X19	R3/8"X19	27.5	28.5	16	
1BT9-06-04SP	G3/8"X19	R1/4"X19	27.5	26.5	16	
1BT9-06-08SP	G3/8"X19	R1/2"X14	31	36	22	
1BT9-08SP	G1/2"X14	R1/2"X14	34.5	36	22	
1BT9-08-04SP	G1/2"X14	R1/4"X19	34.5	30.5	22	
1BT9-08-06SP	G1/2"X14	R3/8"X19	34.5	32.5	22	
1BT9-08-12SP	G1/2"X14	R3/4"X14	37.5	43.5	27	
1BT9-08-16SP	G1/2"X14	R1"X11	41	50	33	
1BT9-10-08SP	G5/8"X14	R1/2"X14	35	36	22	



1BT9-12SP	G3/4"X14	R3/4"X14	40	43.5	27	
1BT9-12-06SP	G3/4"X14	R3/8"X19	40	36	27	
1BT9-12-08SP	G3/4"X14	R1/2"X14	40	39.5	27	
1BT9-12-16SP	G3/4"X14	R1"X11	43.5	50	33	
1BT9-12-20SP	G3/4"X14	R1.1/4"X11	48	56.5	41	
1BT9-16SP	G1"X11	R1"X11	46	50	33	
1BT9-16-08SP	G1"X11	R1/2"X14	46	43	33	
1BT9-16-12SP	G1"X11	R3/4"X14	46	47.5	33	
1BT9-16-20SP	G1"X11	R1.1/4"X11	50.5	56.5	41	
1BT9-20SP	G1.1/4"X11	R1.1/4"X11	52	59	41	
1BT9-20-12SP	G1.1/4"X11	R3/4"X14	50.5	52	41	
1BT9-20-16SP	G1.1/4"X11	R1"X11	52	56.5	41	
1BT9-20-24SP	G1.1/4"X11	R1.1/2"X11	54.5	62.5	48	
1BT9-24SP	G1.1/2"X11	R1.1/2"X11	57.5	62.5	48	
1BT9-24-20SP	G1.1/2"X11	R1.1/4"X11	57.5	61	48	
1BT9-24-32SP	G1.1/2"X11	R2"X11	65	75	63	
1BT9-32SP	G2"X11	R2"X11	67	75	63	
1BT9-32-24SP	G2"X11	R1.1/2"X11	67	72	63	

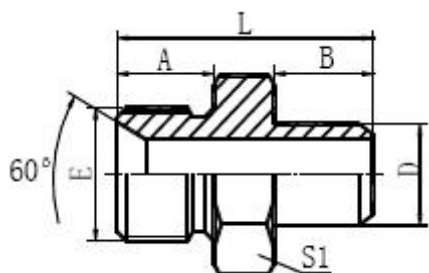

## 1BW

英管外螺纹 60°内锥/焊接管

BSP MALE 60° SEAT/BUTT-WELD TUBE

代号 P/N	螺纹 Thread		尺寸 DIMENSIONS				
	E		A	B	D	L	S1
1BW-04-10	G1/4"X19		12	7	10	25	19
1BW-06-14	G3/8"X19		13.5	8	14	29.5	22
1BW-08-18	G1/2"X14		16	10	18	36	27
1BW-12-22	G3/4"X14		18.5	10	22	39.5	32
1BW-12-28	G3/4"X14		18.5	12	28	41.5	32
1BW-16-28	G1"X11		20.5	12	28	45.5	41
1BW-20-34	G1.1/4"X11		20.5	14	34	49.5	50
1BW-20-42	G1.1/4"X11		20.5	16	42	51.5	50
1BW-24-42	G1.1/2"X11		23	16	42	54	55
1BW-24-50	G1.1/2"X11		23	16	50	54	55
1BW-32-57	G2"X11		25.5	20	57	62.5	70
1BW-32-60	G2"X11		25.5	20	60	62.5	70
1BW-32-63	G2"X11		25.5	20	63	62.5	70
1BW-32-77	G2"X11		25.5	20	77	64.5	80

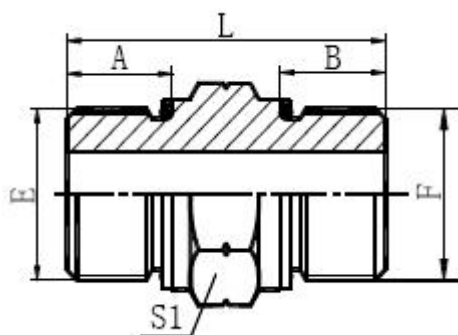

# 1G

英管外螺纹 O 形圈

BSP MALE O-RING

代号 P/N	螺纹 Thread		O 形圈 O-RING		尺寸 DIMENSIONS			
	E	F	E END	F END	A	B	L	S1
1G-02	G1/8"X28	G1/8"X28	7.65X1.78	7.65X1.78	9.5	9.5	28.5	14
1G-04	G1/4"X19	G1/4"X19	10.77X2.62	10.77X2.62	10	10	30	19
1G-06	G3/8"X19	G3/8"X19	13.94X2.62	13.94X2.62	11.5	11.5	33.5	22
1G-08	G1/2"X14	G1/2"X14	17.12X2.62	17.12X2.62	14	14	42	27
1G-12	G3/4"X14	G3/4"X14	23.47X2.62	23.47X2.62	15.5	15.5	46	32
1G-16	G1"X11	G1"X11	29.74X3.53	29.74X3.53	18	18	54.5	41
1G-20	G1.1/4"X11	G1.1/4"X11	37.69X3.53	37.69X3.53	20	20	61	50
1G-24	G1.1/2"X11	G1.1/2"X11	44.04X3.53	44.04X3.53	21.5	21.5	64	55

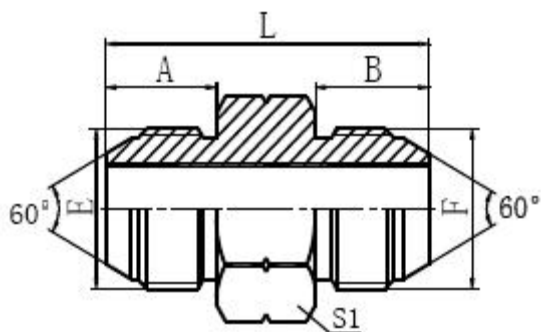

# 1S

英管外螺纹 60°外锥

JIS GAS MALE 60° CONE

代号 P/N	螺纹 Thread		尺寸 DIMENSIONS				
	E	F	A	B	L	S1	
1S-02	G1/8"X28	G1/8"X28	12	12	30	14	
1S-04	G1/4"X19	G1/4"X19	14	14	34	19	
1S-06	G3/8"X19	G3/8"X19	16	16	40	22	
1S-08	G1/2"X14	G1/2"X14	19	19	48	27	
1S-12	G3/4"X14	G3/4"X14	21	21	52	32	
1S-16	G1"X11	G1"X11	23	23	59	41	
1S-20	G1.1/4"X1	G1.1/4"X1	27	27	67	46	
1S-24	G1.1/2"X1	G1.1/2"X1	27	27	69	50	
1S-32	G2"X11	G2"X11	33	33	83	65	

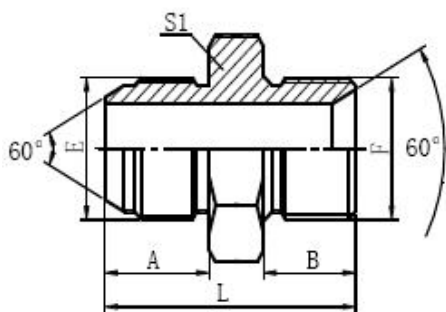

### 1SB

日式英管外螺纹 60°外锥/英管外螺纹 60°内锥

JIS GAS MALE 60° CONE/BSP MALE 60° SEAT

代号 P/N	螺纹 Thread		尺寸 DIMENSIONS				
	E	F	A	B	L	S1	
1SB-04	G1/4"X1	G1/4"X1	14	12	32	19	
1SB-06	G3/8"X1	G3/8"X1	16	13.5	37.5	22	
1SB-08	G1/2"X1	G1/2"X1	19	16	45	27	
1SB-12	G3/4"X1	G3/4"X1	21	18.5	50.5	32	
1SB-16	G1"X11	G1"X11	23	20.5	56.5	41	

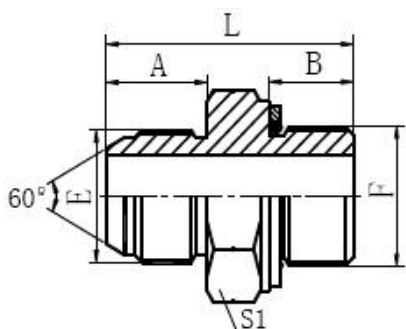

### 1SG

英管外螺纹 60°外锥/英管外螺纹带 O 形圈

JIS GAS MALE 60° CONE/BSP MALE WITH O-RING

代号 P/N	螺纹 Thread		O 形圈 O-RING		尺寸 DIMENSIONS			
	E	F		F END	A	B	L	S1
1SG-02	G1/8"X28	G1/8"X28		7.65X1.78	12	9.5	27.5	14
1SG-04	G1/4"X19	G1/4"X19		10.77X2.62	14	10	30	19
1SG-06	G3/8"X19	G3/8"X19		13.94X2.62	16	11.5	35.5	22
1SG-08	G1/2"X14	G1/2"X14		17.12X2.62	19	14	43	27
1SG-12	G3/4"X14	G3/4"X14		23.47X2.62	21	15.5	47.5	32
1SG-16	G1"X11	G1"X11		29.74X3.53	23	18	54	41
1SG-20	G1.1/4"X11	G1.1/4"X11		37.69X3.53	27	20	62	50
1SG-24	G1.1/2"X11	G1.1/2"X11		44.04X3.53	27	21.5	63.5	55

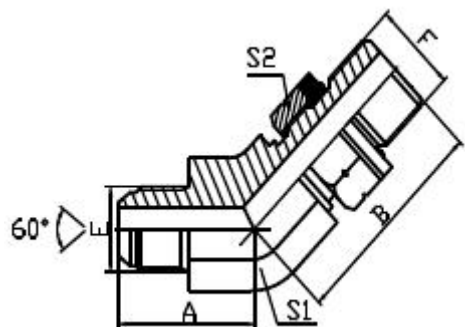

## 1SG4-OG

45°英管外螺纹 60°锥/英管外螺纹带 O 形圈

45° JIS GAS MALE 60°CONE/BSP MALE WITH O-RING

代号 P/N	螺纹 Thread		O 形圈 O-RING		尺寸 DIMENSIONS			
	E	F		F END	A	B	S1	S2
1SG4-02OG	G1/8"X28	G1/8"X28		7.65X1.78	19	24	11	14
1SG4-04OG	G1/4"X19	G1/4"X19		10.77X2.62	21.8	27	14	19
1SG4-06OG	G3/8"X19	G3/8"X19		13.94X2.62	24	30	16	22
1SG4-08OG	G1/2"X14	G1/2"X14		17.12X2.62	29.5	36	22	27
1SG4-12OG	G3/4"X14	G3/4"X14		23.47X2.62	32.8	42	27	32
1SG4-16OG	G1"X11	G1"X11		29.74X3.53	37	44	33	41
1SG4-20OG	G1.1/4"X11	G1.1/4"X11		37.69X3.53	44.5	47.5	41	50
1SG4-24OG	G1.1/2"X11	G1.1/2"X11		44.04X3.53	47.5	51.5	48	55

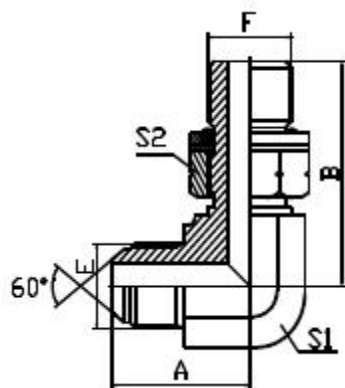

## 1SG9-OG

90°英管外螺纹 60°锥/英管外螺纹带 O 形圈

90° JIS GAS MALE 60° CONE/BSP MALE WITH O-RING

代号 P/N	螺纹 Thread		O 形圈 O-RING		尺寸 DIMENSIONS			
	E	F		F END	A	B	S1	S2
1SG9-02OG	G1/8"X28	G1/8"X28		7.65X1.78	21.8	26.2	11	14
1SG9-04OG	G1/4"X19	G1/4"X19		10.77X2.62	26.3	31.3	14	19
1SG9-06OG	G3/8"X19	G3/8"X19		13.94X2.62	29	35.8	16	22
1SG9-08OG	G1/2"X14	G1/2"X14		17.12X2.62	37	43.2	22	27
1SG9-12OG	G3/4"X14	G3/4"X14		23.47X2.62	41.5	49.3	27	32
1SG9-16OG	G1"X11	G1"X11		29.74X3.53	47.5	53	33	41
1SG9-20OG	G1.1/4"X11	G1.1/4"X11		37.69X3.53	57	58	41	50
1SG9-24OG	G1.1/2"X11	G1.1/2"X11		44.04X3.53	61	63	48	55

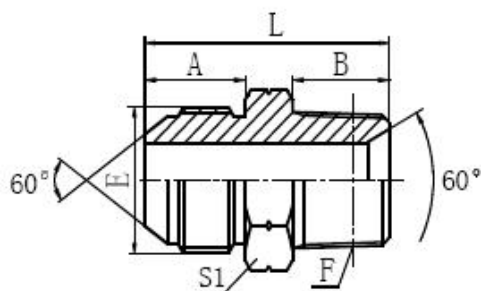

## 1ST-SP

英管外螺纹 60°外锥/英锥管外螺纹

JIS GAS MALE 60° CONE/BSPT MALE

代号 P/N	螺纹 Thread		尺寸 DIMENSIONS			
	E	F	A	B	L	S1
1ST-02SP	G1/8"X28	R1/8"X28	12	10	28	14
1ST-02-04SP	G1/8"X28	R1/4"X19	12	14.5	32.5	17
1ST-04SP	G1/4"X19	R1/4"X19	14	14.5	34.5	19
1ST-04-02SP	G1/4"X19	R1/8"X28	14	10	30	19
1ST-04-06SP	G1/4"X19	R3/8"X19	14	15	37	22
1ST-04-08SP	G1/4"X19	R1/2"X14	14	20	44	27
1ST-06SP	G3/8"X19	R3/8"X19	16	15	39	22
1ST-06-04SP	G3/8"X19	R1/4"X19	16	14.5	38	22
1ST-06-08SP	G3/8"X19	R1/2"X14	16	20	44	24
1ST-06-12SP	G3/8"X19	R3/4"X14	16	20	47	32
1ST-08SP	G1/2"X14	R1/2"X14	19	20	48.5	27
1ST-08-04SP	G1/2"X14	R1/4"X19	19	14.5	43.5	27
1ST-08-06SP	G1/2"X14	R3/8"X19	19	15	44	27
1ST-08-12SP	G1/2"X14	R3/4"X14	19	20	49	30
1ST-12SP	G3/4"X14	R3/4"X14	21	20	52	32
1ST-12-06SP	G3/4"X14	R3/8"X19	21	15	47	32
1ST-12-08SP	G3/4"X14	R1/2"X14	21	20	52	32
1ST-12-16SP	G3/4"X14	R1"X11	21	25.5	59.5	41
1ST-16SP	G1"X11	R1"X11	23	25.5	61.5	41
1ST-20SP	G1.1/4"X11	R1.1/4"X11	27	26.5	66	46
1ST-24SP	G1.1/2"X11	R1.1/2"X11	27	26.5	67.5	50



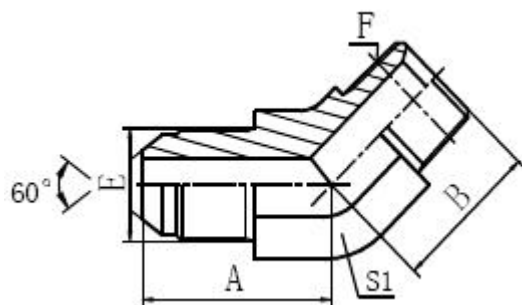

## 1ST4-SP

45°英管外螺纹 60°外锥/英锥管外螺纹

45° JIS GAS MALE 60° CONE/BSPT MALE

代号 P/N	螺纹 Thread		尺寸 DIMENSIONS			
	E	F	A	B	S1	
1ST4-02SP	G1/8"X28	R1/8"X28	19	17	11	
1ST4-02-04SP	G1/8"X28	R1/4"X19	19.8	21	14	
1ST4-04SP	G1/4"X19	R1/4"X19	21.8	21	14	
1ST4-04-02SP	G1/4"X19	R1/8"X28	21.8	17.5	14	
1ST4-04-06SP	G1/4"X19	R3/8"X19	22	23	16	
1ST4-04-08SP	G1/4"X19	R1/2"X14	24	29.5	22	
1ST4-06SP	G3/8"X19	R3/8"X19	24	22	16	
1ST4-06-04SP	G3/8"X19	R1/4"X19	24	21	16	
1ST4-06-08SP	G3/8"X19	R1/2"X14	26	29.5	22	
1ST4-06-12SP	G3/8"X19	R3/4"X14	27.3	30.5	27	
1ST4-08SP	G1/2"X14	R1/2"X14	29.5	29.5	22	
1ST4-08-06SP	G1/2"X14	R3/8"X19	29.5	25	22	
1ST4-08-12SP	G1/2"X14	R3/4"X14	30.8	30.5	27	
1ST4-12SP	G3/4"X14	R3/4"X14	32.8	30.5	27	
1ST4-12-08SP	G3/4"X14	R1/2"X14	32.8	30	27	
1ST4-12-16SP	G3/4"X14	R1"X11	34.5	38	33	
1ST4-16SP	G1"X11	R1"X11	37	38	33	
1ST4-16-12SP	G1"X11	R3/4"X14	37	32.5	33	
1ST4-20SP	G1.1/4"X11	R1.1/4"X11	44.5	43	41	
1ST4-24SP	G1.1/2"X11	R1.1/2"X11	47.5	47.5	48	
1ST4-32SP	G2"X11	R2"X11	53	53	63	

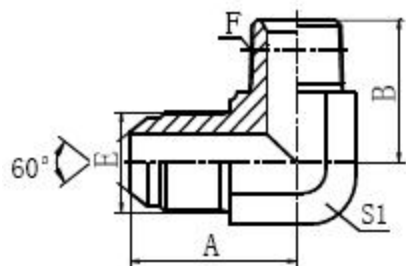

## 1ST9-SP

90°英管外螺纹 60°外锥/英锥管外螺纹

90° JIS GAS MALE 60° CONE/BSPT MALE

代号 P/N	螺纹 Thread		尺寸 DIMENSIONS			
	E	F	A	B	S1	
1ST9-02SP	G1/8"X28	R1/8"X28	21.8	21	11	
1ST9-02-04SP	G1/8"X28	R1/4"X19	24.3	25.5	14	
1ST9-04SP	G1/4"X19	R1/4"X19	26.3	25.5	14	
1ST9-04-02SP	G1/4"X19	R1/8"X28	26.3	23.5	14	
1ST9-04-06SP	G1/4"X19	R3/8"X19	27.7	28.5	16	
1ST9-04-08SP	G1/4"X19	R1/2"X14	31	32.5	22	
1ST9-06SP	G3/8"X19	R3/8"X19	29	28.5	16	
1ST9-06-04SP	G3/8"X19	R1/4"X19	29	26.5	16	
1ST9-06-08SP	G3/8"X19	R1/2"X14	33.5	36	22	
1ST9-06-12SP	G3/8"X19	R3/4"X14	36.5	43.5	27	
1ST9-08SP	G1/2"X14	R1/2"X14	37	35	22	
1ST9-08-04SP	G1/2"X14	R1/4"X19	37	30.5	22	
1ST9-08-06SP	G1/2"X14	R3/8"X19	37	32.5	22	
1ST9-08-12SP	G1/2"X14	R3/4"X14	40	43.5	27	
1ST9-12SP	G3/4"X14	R3/4"X14	41.5	43.5	27	
1ST9-12-06SP	G3/4"X14	R3/8"X19	41.5	36	27	
1ST9-12-08SP	G3/4"X14	R1/2"X14	41.5	39.5	27	
1ST9-12-16SP	G3/4"X14	R1"X11	45.5	50	33	
1ST9-16SP	G1"X11	R1"X11	47.5	50	33	
1ST9-16-12SP	G1"X11	R3/4"X14	47.5	47.5	33	
1ST9-20SP	G1.1/4"X11	R1.1/4"X11	57	56.5	41	
1ST9-24SP	G1.1/2"X11	R1.1/2"X11	61	62.5	48	

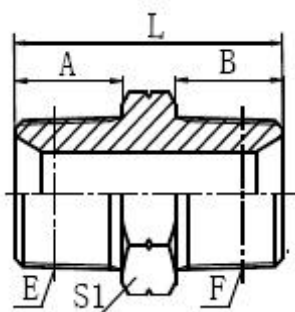

## 1T-SP

英锥管外螺纹

BSPT MALE

代号 P/N	螺纹 Thread		尺寸 DIMENSIONS			
	E	F	A	B	L	S1
1T-02SP	R1/8"X28	R1/8"X28	10	10	26	12
1T-02-04SP	R1/8"X28	R1/4"X19	10	14.5	30.5	17
1T-02-06SP	R1/8"X28	R3/8"X19	10	15	31	19
1T-04SP	R1/4"X19	R1/4"X19	14.5	14.5	34	17
1T-04-06SP	R1/4"X19	R3/8"X19	14.5	15	35	19
1T-04-08SP	R1/4"X19	R1/2"X14	15	20	43	22
1T-04-12SP	R1/4"X19	R3/4"X14	15	20	45	30
1T-06SP	R3/8"X19	R3/8"X19	15	15	36	19
1T-06-08SP	R3/8"X19	R1/2"X14	15	20	43	22
1T-06-12SP	R3/8"X19	R3/4"X14	15	20	44.5	30
1T-06-16SP	R3/8"X19	R1"X11	16	25.5	51.5	36
1T-08SP	R1/2"X14	R1/2"X14	20	20	46	22
1T-08-12SP	R1/2"X14	R3/4"X14	20	20	48	30
1T-08-16SP	R1/2"X14	R1"X11	20	25.5	56.5	36
1T-12SP	R3/4"X14	R3/4"X14	20	20	48	30
1T-12-16SP	R3/4"X14	R1"X11	20	25.5	55.5	36
1T-12-20SP	R3/4"X14	R1.1/4"X11	20	26.5	58.5	46
1T-16SP	R1"X11	R1"X11	25.5	25.5	61	36
1T-16-20SP	R1"X11	R1.1/4"X11	25.5	26.5	64.5	46
1T-16-24SP	R1"X11	R1.1/2"X11	25.5	26.5	66	50
1T-20SP	R1.1/4"X11	R1.1/4"X11	26.5	26.5	65.5	46

1T-20-24SP	R1.1/4"X11	R1.1/2"X11	26.5	26.5	67	50
1T-24SP	R1.1/2"X11	R1.1/2"X11	26.5	26.5	67	50
1T-24-32SP	R1.1/2"X11	R2"X11	26.5	30	71.5	65
1T-32SP	R2"X11	R2"X11	30	30	75	65

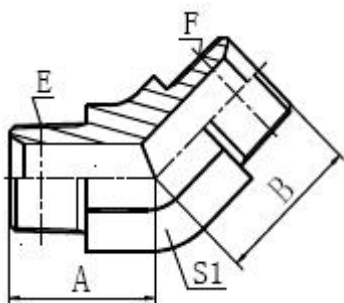

## 1T4-SP

45°英锥管外螺纹

45° BSPT MALE

代号 P/N	螺纹 Thread		尺寸 DIMENSIONS			
	E	F	A	B	S1	
1T4-02SP	R1/8"X28	R1/8"X28	17	17	11	
1T4-04SP	R1/4"X19	R1/4"X19	21	21	14	
1T4-04-06SP	R1/4"X19	R3/8"X19	21	23	16	
1T4-06SP	R3/8"X19	R3/8"X19	23	23	16	
1T4-06-08SP	R3/8"X19	R1/2"X14	25	29.5	22	
1T4-08SP	R1/2"X14	R1/2"X14	29.5	29.5	22	
1T4-08-12SP	R1/2"X14	R3/4"X14	30	30.5	27	
1T4-12SP	R3/4"X14	R3/4"X14	30.5	30.5	27	
1T4-12-16SP	R3/4"X14	R1"X11	32.5	38	33	
1T4-16SP	R1"X11	R1"X11	38	38	33	
1T4-16-20SP	R1"X11	R1.1/4"X11	42	43	41	
1T4-20SP	R1.1/4"X11	R1.1/4"X11	43	43	41	
1T4-24SP	R1.1/2"X11	R1.1/2"X11	47.5	47.5	48	
1T4-32SP	R2"X11	R2"X11	53	53	63	

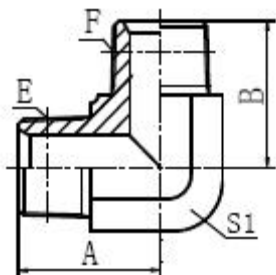

## 1T9-SP

90°英锥管外螺纹

90° BSPT MALE

代号 P/N	螺纹 Thread		尺寸 DIMENSIONS			
	E	F	A	B	S1	
1T9-02SP	R1/8"X28	R1/8"X28	21	21	11	
1T9-04SP	R1/4"X19	R1/4"X19	25.5	25.5	14	
1T9-04-06SP	R1/4"X19	R3/8"X19	26.5	28.5	16	
1T9-06SP	R3/8"X19	R3/8"X19	28.5	28.5	16	
1T9-06-08SP	R3/8"X19	R1/2"X14	32.5	36	22	
1T9-08SP	R1/2"X14	R1/2"X14	36	36	22	
1T9-08-12SP	R1/2"X14	R3/4"X14	39.5	43.5	27	
1T9-12SP	R3/4"X14	R3/4"X14	43.5	43.5	27	
1T9-12-16SP	R3/4"X14	R1"X11	48	50	33	
1T9-16SP	R1"X11	R1"X11	50	50	33	
1T9-16-20SP	R1"X11	R1.1/4"X11	56.5	57.5	41	
1T9-20SP	R1.1/4"X11	R1.1/4"X11	56.5	56.5	41	
1T9-24SP	R1.1/2"X11	R1.1/2"X11	62.5	62.5	48	
1T9-32SP	R2"X11	R2"X11	68	75	63	

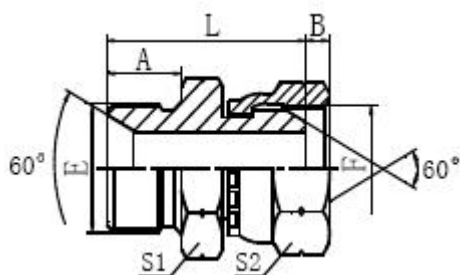

## 2B

英管外螺纹 60°内锥/英管内螺纹 60°外锥

BSP MALE 60°SEAT/BSP FEMALE 60° CONE

代号 P/N	螺纹 Thread		尺寸 DIMENSIONS				
	E	F	A	B	L	S1	S2
2B-02	G1/8"X28	G1/8"X28	10	5.5	25	14	14
2B-04	G1/4"X19	G1/4"X19	12	5.5	29	19	19
2B-04-06	G1/4"X19	G3/8"X19	12	6.3	30.5	19	22
2B-04-08	G1/4"X19	G1/2"X14	12	7.5	32	19	27
2B-06	G3/8"X19	G3/8"X19	13.5	6.3	34	22	22
2B-06-04	G3/8"X19	G1/4"X19	13.5	5.5	32.5	22	19
2B-06-08	G3/8"X19	G1/2"X14	13.5	7.5	35.5	22	27
2B-08	G1/2"X14	G1/2"X14	16	7.5	40	27	27
2B-08-04	G1/2"X14	G1/4"X19	16	5.5	37	27	19
2B-08-06	G1/2"X14	G3/8"X19	16	6.3	38.5	27	22
2B-08-10	G1/2"X14	G5/8"X14	16	9.5	40.5	27	30
2B-08-12	G1/2"X14	G3/4"X14	16	10.9	41	27	32
2B-10	G5/8"X14	G5/8"X14	17.5	9.5	42	30	30
2B-10-08	G5/8"X14	G1/2"X14	17.5	7.5	41.5	30	27
2B-10-12	G5/8"X14	G3/4"X14	17.5	10.9	42.5	30	32
2B-12	G3/4"X14	G3/4"X14	18.5	10.9	44.5	32	32
2B-12-08	G3/4"X14	G1/2"X14	18.5	7.5	43.5	32	27
2B-12-16	G3/4"X14	G1"X11	18.5	11.7	46	32	41
2B-16	G1"X11	G1"X11	20.5	11.7	50	41	41
2B-16-12	G1"X11	G3/4"X14	20.5	10.9	49	41	32
2B-16-20	G1"X11	G1.1/4"X11	20.5	11	52	41	50

2B-20	G1.1/4"X11	G1.1/4"X11	20.5	11	54	50	50
2B-20-16	G1.1/4"X11	G1"X11	20.5	11.7	52	50	41
2B-20-24	G1.1/4"X11	G1.1/2"X11	20.5	13	54.5	50	55
2B-20-32	G1.1/4"X11	G2"X11	20.5	16	57.5	60	70
2B-24	G1.1/2"X11	G1.1/2"X11	23	13	57	55	55
2B-32	G2"X11	G2"X11	25.5	16	64.5	70	70

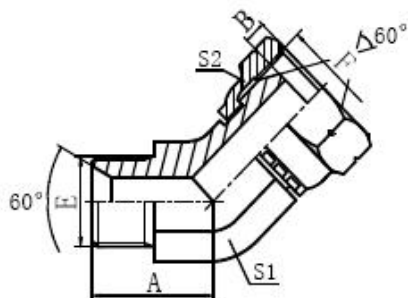

## 2B4

45°英管外螺纹 60°内锥/英管内螺纹 60°外锥

45° BSP MALE 60° SEAT/BSP FEMALE 60°CONE

代号 P/N	螺纹 Thread		尺寸 DIMENSIONS				
	E	F	A	B	S1	S2	
2B4-02	G1/8"X28	G1/8"X28	17	5.5	11	14	
2B4-04	G1/4"X19	G1/4"X19	20.3	5.5	14	19	
2B4-04-06	G1/4"X19	G3/8"X19	20.3	6.3	14	22	
2B4-06	G3/8"X19	G3/8"X19	22	6.3	16	22	
2B4-06-04	G3/8"X19	G1/4"X19	22	5.5	16	19	
2B4-06-08	G3/8"X19	G1/2"X14	23	7.5	19	27	
2B4-08	G1/2"X14	G1/2"X14	27	7.5	22	27	
2B4-08-06	G1/2"X14	G3/8"X19	27	6.3	22	22	
2B4-08-12	G1/2"X14	G3/4"X14	27.5	10.9	24	32	
2B4-10	G5/8"X14	G5/8"X14	28.5	9.5	22	30	
2B4-10-08	G5/8"X14	G1/2"X14	28.5	7.5	22	27	
2B4-10-12	G5/8"X14	G3/4"X14	29	10.9	24	32	
2B4-12	G3/4"X14	G3/4"X14	31	10.9	27	32	
2B4-12-08	G3/4"X14	G1/2"X14	31	7.5	27	27	
2B4-12-16	G3/4"X14	G1"X11	32	11.7	30	41	

2B4-16	G1"X11	G1"X11	35	11.7	33	41	
2B4-16-12	G1"X11	G3/4"X14	35	10.9	33	32	
2B4-16-20	G1"X11	G1.1/4"X11	38.5	11	41	50	
2B4-20	G1.1/4"X11	G1.1/4"X11	38.5	11	41	50	
2B4-20-16	G1.1/4"X11	G1"X11	38.5	11.7	41	41	
2B4-20-24	G1.1/4"X11	G1.1/2"X11	41.5	13	48	55	
2B4-24	G1.1/2"X11	G1.1/2"X11	44	13	48	55	
2B4-32	G2"X11	G2"X11	51	16	63	70	

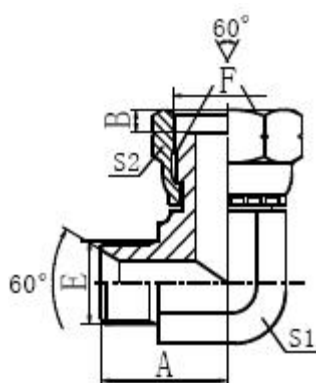

## 2B9

90°英管外螺纹 60°内锥/英管内螺纹 60°外锥

90° BSP MALE 60° SEAT/BSP FEMALE 60°CONE

代号 P/N	螺纹 Thread		尺寸 DIMENSIONS				
	E	F	A	B	S1	S2	
2B9-04	G1/4"X19	G1/4"X19	24.5	5.5	14	19	
2B9-04-06	G1/4"X19	G3/8"X19	24.5	6.3	14	22	
2B9-06	G3/8"X19	G3/8"X19	27.5	6.3	16	22	
2B9-06-04	G3/8"X19	G1/4"X19	27.5	5.5	16	19	
2B9-06-08	G3/8"X19	G1/2"X14	28.5	7.5	19	27	
2B9-08	G1/2"X14	G1/2"X14	34.5	7.5	22	27	
2B9-08-06	G1/2"X14	G3/8"X19	34.5	6.3	22	22	
2B9-08-10	G1/2"X14	G5/8"X14	33.5	31	24	30	
2B9-08-12	G1/2"X14	G3/4"X14	35.5	10.9	24	32	
2B9-08-16	G1/2"X14	G1"X11	41	40.5	36	41	
2B9-10	G5/8"X14	G5/8"X14	35	9.5	22	30	
2B9-10-08	G5/8"X14	G1/2"X14	35	7.5	22	27	



2B9-12	G3/4"X14	G3/4"X14	40	10.9	27	32	
2B9-12-08	G3/4"X14	G1/2"X14	40	7.5	27	27	
2B9-12-16	G3/4"X14	G1"X11	41.5	11.7	30	41	
2B9-16	G1"X11	G1"X11	46	11.7	33	41	
2B9-16-12	G1"X11	G3/4"X14	46	10.9	33	32	
2B9-16-20	G1"X11	G1.1/4"X11	50.5	11	41	50	
2B9-20	G1.1/4"X11	G1.1/4"X11	50.5	11	41	50	
2B9-20-16	G1.1/4"X11	G1"X11	50.5	11.7	41	41	
2B9-20-24	G1.1/4"X11	G1.1/2"X11	54.5	13	48	55	
2B9-24	G1.1/2"X11	G1.1/2"X11	57.5	13	48	55	
2B9-32	G2"X11	G2"X11	70	16	63	70	

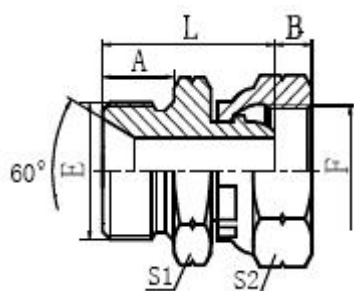

## 2BA

英管外螺纹 60°内锥/英管内螺纹球面

BSP MALE 60° SEAT/BSP FEMALE MULTISEAL

代号 P/N	螺纹 Thread		尺寸 DIMENSIONS				
	E	F	A	B	L	S1	S2
2BA-02	G1/8"X28	G1/8"X28	10	2	28.5	14	14
2BA-04	G1/4"X19	G1/4"X19	12	4	30.5	19	19
2BA-06	G3/8"X19	G3/8"X19	13.5	5	35	22	22
2BA-08	G1/2"X14	G1/2"X14	16	6	41.5	27	27
2BA-10	G5/8"X14	G5/8"X14	17.5	8	43.5	30	30
2BA-12	G3/4"X14	G3/4"X14	18.5	9	46.5	32	32
2BA-16	G1"X11	G1"X11	20.5	10.5	51	41	41
2BA-20	G1.1/4"X11	G1.1/4"X11	20.5	10	55	50	50
2BA-24	G1.1/2"X11	G1.1/2"X11	23	11	59	55	55
2BA-32	G2"X11	G2"X11	25.5	15	65.5	70	70

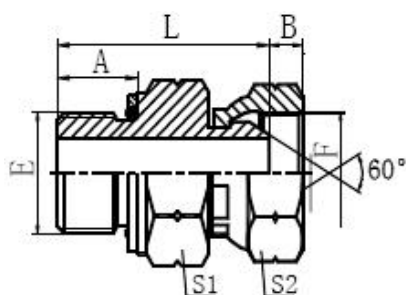

## 2GB

英管外螺纹 O 形圈/英管内螺纹

BSP MALE O-RING/BSP 60° FEMALE

代号 P/N	螺纹 Thread		O 形圈 O-RING		尺寸 DIMENSIONS				
	E	F	F END	E END	A	B	L	S1	S2
2GB-02	G1/8"X28	G1/8"X28	7.65X1.78		9.5	5.5	24.5	14	14
2GB-04-02	G1/4"X19	G1/8"X28	10.77X2.62		10	5.5	25	19	14
2GB-04-06	G1/4"X19	G3/8"X19	10.77X2.62		10	6.3	28.2	19	22
2GB-06	G3/8"X19	G3/8"X19	13.94X2.62		11.5	6.3	31.7	22	22
2GB-06-04	G3/8"X19	G1/4"X19	13.94X2.62		11.5	5.5	30.5	22	19
2GB-06-08	G3/8"X19	G1/2"X14	13.94X2.62		11.5	7.5	33.5	22	27
2GB-08	G1/2"X14	G1/2"X14	17.12X2.62		14	7.5	38	27	27
2GB-08-06	G1/2"X14	G3/8"X19	17.12X2.62		14	6.3	36.2	27	22
2GB-08-10	G1/2"X14	G5/8"X14	17.12X2.62		14	9.5	38.5	27	30
2GB-08-12	G1/2"X14	G3/4"X14	17.12X2.62		14	10.9	39.1	27	32
2GB-12	G3/4"X14	G3/4"X14	23.47X2.62		15.5	10.9	40.6	32	32
2GB-12-08	G3/4"X14	G1/2"X14	23.47X2.62		15.5	7.5	39.5	32	27
2GB-12-16	G3/4"X14	G1"X11	23.47X2.62		15.5	11.7	41.8	32	41
2GB-16	G1"X11	G1"X11	29.74X3.53		18	11.7	47.3	41	41
2GB-16-12	G1"X11	G3/4"X14	29.74X3.53		18	10.9	46.1	41	32
2GB-20	G1.1/4"X11	G1.1/4"X11	37.69X3.53		20	11	53.5	50	50
2GB-20-16	G1.1/4"X11	G1"X11	37.69X3.53		20	11.7	51.3	50	41
2GB-24	G1.1/2"X11	G1.1/2"X11	44.04X3.53		21.5	13	55.5	55	55

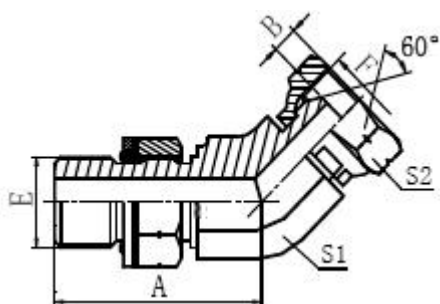

## 2GB4-OG

45°英管外螺纹 O 形圈/英管内螺纹 60°外锥

45° BSP MALE O-RING/BSP MALE 60°CONE

代号 P/N	螺纹 Thread		O 形圈 O-RING		尺寸 DIMENSIONS				
	E	F	F END	E END	A	B	S1	S2	
2GB4-02OG	G1/8"X28	G1/8"X28	7.65X1.78		24	5.5	11	14	
2GB4-04-02O	G1/4"X19	G1/8"X28	10.77X2.62		27	5.5	14	14	
2GB4-04-06O	G1/4"X19	G3/8"X19	10.77X2.62		27	6.3	14	22	
2GB4-06OG	G3/8"X19	G3/8"X19	13.94X2.62		30	6.3	16	22	
2GB4-06-04O	G3/8"X19	G1/4"X19	13.94X2.62		30	5.5	16	19	
2GB4-06-08O	G3/8"X19	G1/2"X14	13.94X2.62		31	7.5	19	27	
2GB4-08OG	G1/2"X14	G1/2"X14	17.12X2.62		36	7.5	22	27	
2GB4-08-06O	G1/2"X14	G3/8"X19	17.12X2.62		36	6.3	22	22	
2GB4-08-10O	G1/2"X14	G5/8"X14	17.12X2.62		36	9.5	22	30	
2GB4-08-12O	G1/2"X14	G3/4"X14	17.12X2.62		36.5	10.9	24	32	
2GB4-12OG	G3/4"X14	G3/4"X14	23.47X2.62		42	10.9	27	32	
2GB4-12-08O	G3/4"X14	G1/2"X14	23.47X2.62		42	7.5	27	27	
2GB4-12-16O	G3/4"X14	G1"X11	23.47X2.62		42.8	11.7	30	41	
2GB4-16OG	G1"X11	G1"X11	29.74X3.53		44	11.7	33	41	
2GB4-16-12O	G1"X11	G3/4"X14	29.74X3.53		44	10.9	33	32	
2GB4-20OG	G1.1/4"X11	G1.1/4"X11	37.69X3.53		47.5	11	41	50	
2GB4-20-16O	G1.1/4"X11	G1"X11	37.69X3.53		47.5	11.7	41	41	
2GB4-24OG	G1.1/2"X11	G1.1/2"X11	44.04X3.53		51.5	13	48	55	

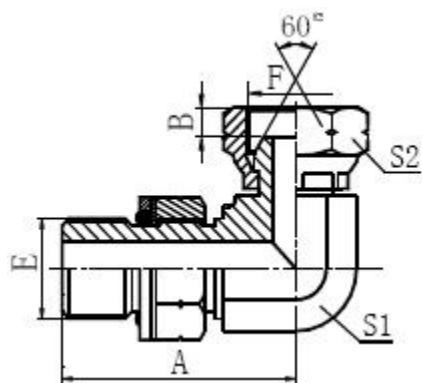

## 2GB9-OG

90°英管外螺纹 O 形圈/英管内螺纹 60°外锥

90° BSP MALE O-RING/BSP MALE 60° CONE

代号 P/N	螺纹 Thread		O 形圈 O-RING		尺寸 DIMENSIONS				
	E	F	F END	E END	A	B	S1	S2	
2GB9-02OG	G1/8"X28	G1/8"X28	7.65X1.78		26.2	5.5	11	14	
2GB9-04-02	G1/4"X19	G1/8"X28	10.77X2.62		31.3	5.5	14	14	
2GB9-04-06	G1/4"X19	G3/8"X19	10.77X2.62		31.3	6.3	14	22	
2GB9-06OG	G3/8"X19	G3/8"X19	13.94X2.62		35.8	6.3	16	22	
2GB9-06-04	G3/8"X19	G1/4"X19	13.94X2.62		35.8	5.5	16	19	
2GB9-06-08	G3/8"X19	G1/2"X14	13.94X2.62		36.8	7.5	19	27	
2GB9-08OG	G1/2"X14	G1/2"X14	17.12X2.62		43.2	7.5	22	27	
2GB9-08-06	G1/2"X14	G3/8"X19	17.12X2.62		43.2	6.3	22	22	
2GB9-08-10	G1/2"X14	G5/8"X14	17.12X2.62		43.2	9.5	22	30	
2GB9-08-12	G1/2"X14	G3/4"X14	17.12X2.62		45	10.9	24	32	
2GB9-12OG	G3/4"X14	G3/4"X14	23.47X2.62		49.3	10.9	27	32	
2GB9-12-08	G3/4"X14	G1/2"X14	23.47X2.62		49.3	7.5	27	27	
2GB9-12-16	G3/4"X14	G1"X11	23.47X2.62		52	11.7	30	41	
2GB9-16OG	G1"X11	G1"X11	29.74X3.53		53	11.7	33	41	
2GB9-16-12	G1"X11	G3/4"X14	29.74X3.53		53	10.9	33	32	
2GB9-20OG	G1.1/4"X11	G1.1/4"X11	37.69X3.53		58	11	41	50	
2GB9-20-16	G1.1/4"X11	G1"X11	37.69X3.53		58	11.7	41	41	
2GB9-24OG	G1.1/2"X11	G1.1/2"X11	44.04X3.53		63	13	48	55	

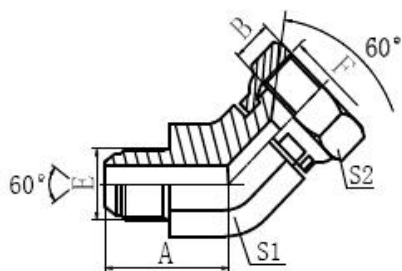

## 2S4

45°日式英管外螺纹/日式英管内螺纹

45° JIS GAS MALE/JIS GAS FEMALE

代号 P/N	螺纹 Thread		O 形圈 O-RING		尺寸 DIMENSIONS				
	E	F	F END	E END	A	B	S1	S2	
2S4-02	G1/8"X28	G1/8"X28			19	6.5	11	14	
2S4-04	G1/4"X19	G1/4"X19			21.8	8	14	19	
2S4-06	G3/8"X19	G3/8"X19			24	9	16	22	
2S4-08	G1/2"X14	G1/2"X14			29.5	12	22	27	
2S4-12	G3/4"X14	G3/4"X14			32.8	13.5	27	32	
2S4-16	G1"X11	G1"X11			37	16	33	41	
2S4-20	G1.1/4"X11	G1.1/4"X11			44.5	18.5	41	50	

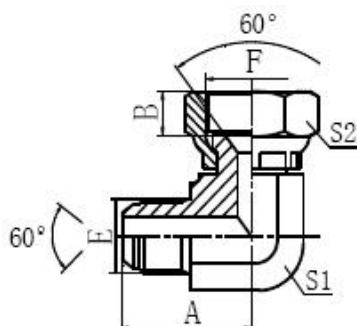

## 2S9

90°日式英管外螺纹/日式英管内螺纹

90° JIS GAS MALE/JIS GAS FEMALE

代号 P/N	螺纹 Thread		O 形圈 O-RING		尺寸 DIMENSIONS				
	E	F	F END	E END	A	B	S1	S2	
2S9-04	G1/4"X19	G1/4"X19			26.3	8	14	19	
2S9-06	G3/8"X19	G3/8"X19			29	9	16	22	
2S9-08	G1/2"X14	G1/2"X14			37	12	22	27	
2S9-12	G3/4"X14	G3/4"X14			41.5	13.5	27	32	
2S9-16	G1"X11	G1"X11			47.5	16	33	41	
2S9-20	G1.1/4"X11	G1.1/4"X11			57	18.5	41	50	

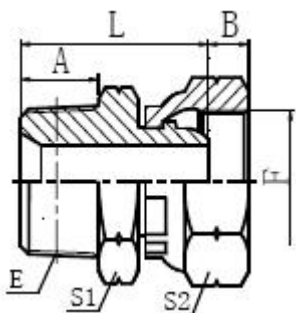

## 2TA-SP

英锥管外螺纹/英管内螺纹球面

BSPT MALE/BSP FEMALE MULTISEAL

代号 P/N	螺纹 Thread		O 形圈 O-RING		尺寸 DIMENSIONS				
	E	F	F END	E END	A	B	L	S1	S2
2TA-02SP	R1/8"X28	G1/8"X28			10	2	28.5	12	14
2TA-04SP	R1/4"X19	G1/4"X19			14.5	4	33	17	19
2TA-06SP	R3/8"X19	G3/8"X19			15	5	35.5	19	22
2TA-08SP	R1/2"X14	G1/2"X14			20	6	43.5	22	27
2TA-12SP	R3/4"X14	G3/4"X14			20.9	9	47	30	32
2TA-16SP	R1"X11	G1"X11			25.5	10.5	54	36	41
2TA-20SP	R1.1/4"X11	G1.1/4"X11			26.5	10	59	46	50
2TA-24SP	R1.1/2"X11	G1.1/2"X11			26.5	11	62.5	50	55
2TA-32SP	R2"X11	G2"X11			30	15	70	65	70

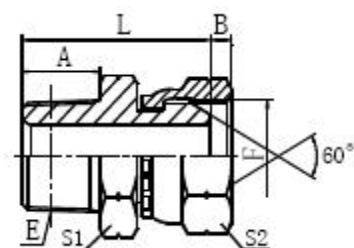

## 2TB-SP

英锥管外螺纹/英管内螺纹 60°外锥

BSPT MALE/BSP FEMALE 60° CONE

代号 P/N	螺纹 Thread		尺寸 DIMENSIONS				
	E	F	A	B	L	S1	S2
2TB-02SP	R1/8"X28	G1/8"X28	10	5.5	25	12	14
2TB-02-04SP	R1/8"X28	G1/4"X19	10	5.5	27	12	19
2TB-04SP	R1/4"X19	G1/4"X19	14.5	5.5	31.5	17	19
2TB-04-02SP	R1/4"X19	G1/8"X28	14.5	5.5	29.5	17	14
2TB-06SP	R3/8"X19	G3/8"X19	15	6.3	33	19	22
2TB-06-04SP	R3/8"X19	G1/4"X19	15	5.5	32	19	19
2TB-06-08SP	R3/8"X19	G1/2"X14	15	7.5	35	19	27
2TB-08SP	R1/2"X14	G1/2"X14	20	7.5	42	22	27
2TB-08-06SP	R1/2"X14	G3/8"X19	20	6.3	40	22	22
2TB-08-12SP	R1/2"X14	G3/4"X14	20	10.9	45	27	32
2TB-12SP	R3/4"X14	G3/4"X14	20	10.9	45	30	32
2TB-12-08SP	R3/4"X14	G1/2"X14	20	7.5	45	30	27
2TB-12-16SP	R3/4"X14	G1"X11	20	11.7	46	32	41
2TB-16SP	R1"X11	G1"X11	25.5	11.7	52.5	36	41
2TB-16-12SP	R1"X11	G3/4"X14	25.5	10.9	51.5	36	32
2TB-16-20SP	R1"X11	G1.1/4"X11	25.5	11	57	41	50
2TB-20-12SP	R1.1/4"X11	G3/4"X14	26.5	10.9	54.5	46	32
2TB-20-16SP	R1.1/4"X11	G1"X11	26.5	11.7	55.5	46	41
2TB-20SP	R1.1/4"X11	G1.1/4"X11	26.5	11	58	46	50
2TB-20-24SP	R1.1/4"X11	G1.1/2"X11	26.5	13	58.5	46	55
2TB-24SP	R1.1/2"X11	G1.1/2"X11	26.5	13	60.5	50	55
2TB-32SP	R2"X11	G2"X11	30	16	68	65	70

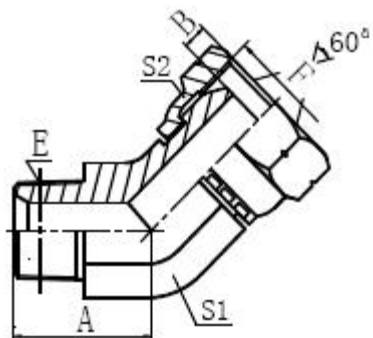

## 2TB4-SP

45° 英锥管外螺纹/英管内螺纹 60°外锥

45° BSPT MALE/BSP FEMALE 60° CONE

代号 P/N	螺纹 Thread		尺寸 DIMENSIONS				
	E	F	A	B	S1	S2	
2TB4-02SP	R1/8"X28	G1/8"X28	17	5.5	11	14	
2TB4-04SP	R1/4"X19	G1/4"X19	21	5.5	14	19	
2TB4-04-06SP	R1/4"X19	G3/8"X19	21	6.3	14	22	
2TB4-06SP	R3/8"X19	G3/8"X19	23	6.3	16	22	
2TB4-06-04SP	R3/8"X19	G1/4"X19	23	5.5	16	19	
2TB4-06-08SP	R3/8"X19	G1/2"X14	24	7.5	19	27	
2TB4-08SP	R1/2"X14	G1/2"X14	29.5	7.5	22	27	
2TB4-08-06SP	R1/2"X14	G3/8"X19	29.5	6.3	22	22	
2TB4-08-12SP	R1/2"X14	G3/4"X14	30	10.9	24	32	
2TB4-12SP	R3/4"X14	G3/4"X14	30.5	10.9	27	32	
2TB4-12-08SP	R3/4"X14	G1/2"X14	30.5	7.5	27	27	
2TB4-12-16SP	R3/4"X14	G1"X11	31.5	11.7	30	41	
2TB4-16SP	R1"X11	G1"X11	38	11.7	33	41	
2TB4-16-12SP	R1"X11	G3/4"X14	38	10.9	33	32	
2TB4-16-20SP	R1"X11	G1.1/4"X11	42	11	41	50	
2TB4-20SP	R1.1/4"X11	G1.1/4"X11	43	11	41	50	
2TB4-20-16SP	R1.1/4"X11	G1"X11	43	11.7	41	41	
2TB4-24SP	R1.1/2"X11	G1.1/2"X11	47.5	13	48	55	
2TB4-32SP	R2"X11	G2"X11	53	16	63	70	



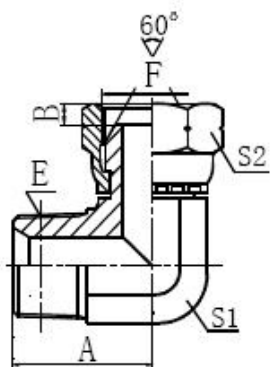

## 2TB9-SP

90° 英锥管外螺纹/英管内螺纹 60°外锥

90° BSPT MALE/BSP FEMALE 60° CONE

代号 P/N	螺纹 Thread		尺寸 DIMENSIONS				
	E	F	A	B	S1	S2	
2TB9-02SP	R1/8"X28	G1/8"X28	21	5.5	11	14	
2TB9-04SP	R1/4"X19	G1/4"X19	25.5	5.5	14	19	
2TB9-04-06SP	R1/4"X19	G3/8"X19	25.5	6.3	14	22	
2TB9-06-04SP	R3/8"X19	G1/4"X19	28.5	5.5	16	19	
2TB9-06SP	R3/8"X19	G3/8"X19	28.5	6.3	16	22	
2TB9-06-08SP	R3/8"X19	G1/2"X14	30.5	7.5	19	27	
2TB9-08-06SP	R1/2"X14	G3/8"X19	36	6.3	22	22	
2TB9-08SP	R1/2"X14	G1/2"X14	36	7.5	22	27	
2TB9-08-12SP	R1/2"X14	G3/4"X14	37.3	10.9	24	32	
2TB9-12-08SP	R3/4"X14	G1/2"X14	43.5	7.5	27	27	
2TB9-12SP	R3/4"X14	G3/4"X14	43.5	10.9	27	32	
2TB9-12-16SP	R3/4"X14	G1"X11	45.3	11.7	30	41	
2TB9-16-12SP	R1"X11	G3/4"X14	50	10.9	33	32	
2TB9-16SP	R1"X11	G1"X11	50	11.7	33	41	
2TB9-16-20SP	R1"X11	G1.1/4"X11	56.5	11	41	50	
2TB9-20-16SP	R1.1/4"X11	G1"X11	56.5	11.7	41	41	
2TB9-20SP	R1.1/4"X11	G1.1/4"X11	58	11	41	50	
2TB9-24SP	R1.1/2"X11	G1.1/2"X11	62.5	13	48	55	
2TB9-32SP	R2"X11	G2"X11	67	16	63	70	

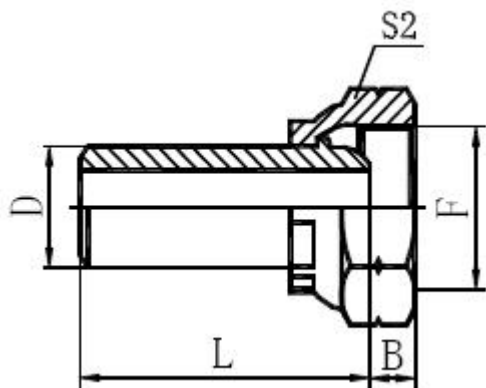

## 2WA

焊接管/英管内螺纹球面

BUTT- WELD TUBE/BSP FEMALE MULTISEAL

代号 P/N	螺纹 Thread		尺寸 DIMENSIONS				
	E	F	B	D	L	S2	
2WA-08-04		G1/4"X19	4	8	40	19	
2WA-10-04		G1/4"X19	4	10	35	19	
2WA-10-06		G3/8"X19	5	10	30	22	
2WA-13-04		G1/4"X19	4	13	40	19	
2WA-12-06		G3/8"X19	5	12	40	22	
2WA-14-06		G3/8"X19	5	14	40	22	
2WA-16-08		G1/2"X14	6	16	45	27	
2WA-17-06		G3/8"X19	5	17	45	22	
2WA-18-08		G1/2"X14	6	18	45	27	
2WA-21-08		G1/2"X14	6	21	50	27	
2WA-21-12		G3/4"X14	9	21	50	32	
2WA-22-12		G3/4"X14	9	22	50	32	
2WA-27-12		G3/4"X14	9	27	50	32	
2WA-27-16		G1"X11	10.5	27	50	41	
2WA-28-16		G1"X11	10.5	28	50	41	
2WA-33-16		G1"X11	10.5	33	55	41	
2WA-34-20		G1.1/4"X11	10	34	55	50	
2WA-42-20		G1.1/4"X11	10	42	55	50	
2WA-50-32		G2"X11	15	50	55	70	
2WA-57-32		G2"X11	15	57	60	70	

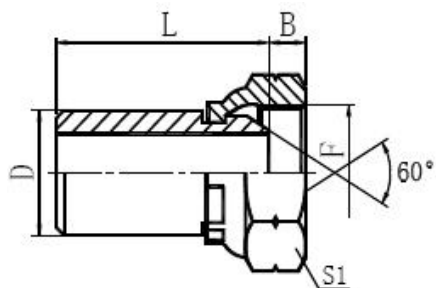

## 2WB

焊接管/英管内螺纹 60°外锥

BUTT-WELD TUBE /BSP FEMALE 60° CONE

代号 P/N	螺纹 Thread		尺寸 DIMENSIONS				
	E	F	B	D	L	S1	
2WB-10-04		G1/4"X19	5.5	10	35	19	
2WB-14-06		G3/8"X19	6.3	14	50	22	
2WB-18-08		G1/2"X14	7.5	18	50	27	
2WB-22-08		G1/2"X14	7.5	22	50	27	
2WB-22-12		G3/4"X14	10.9	22	62	32	
2WB-28-16		G1"X11	11.7	28	65	41	
2WB-34-20		G1.1/4"X11	11	34	68	50	
2WB-42-20		G1.1/4"X11	11	42	68	50	
2WB-60-32		G2"X11	16	60	62	70	

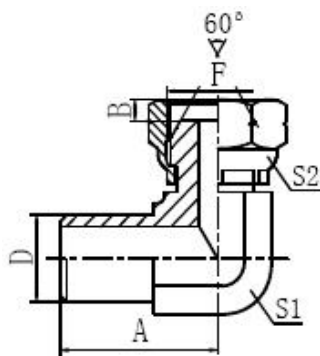

## 2WB9

90° 焊接管/英管内螺纹 60°外锥

90° BUTT-WELD TUBE /BSP FEMALE 60°CONE

代号 P/N	螺纹 Thread		尺寸 DIMENSIONS				
	E	F	A	B	D	S1	S2
2WB9-08-04		G1/4"X19	21	5.5	8	11	19
2WB9-12-06		G3/8"X19	25.5	6.3	12	14	22
2WB9-16-08		G1/2"X14	29.5	7.5	16	19	27
2WB9-22-12		G3/4"X14	35.5	10.9	22	24	32
2WB9-28-16		G1"X11	42	11.7	28	30	41
2WB9-34-20		G1.1/4"X11	49.5	11	34	41	50
2WB9-42-32		G2"X11	66	16	42	63	70

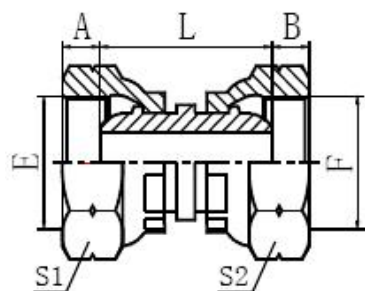

### 3A

英管内螺纹球面

BSP FEMALE MULTISEAL

代号 P/N	螺纹 Thread		尺寸 DIMENSIONS				
	E	F	A	B	L	S1	S2
3A-02	G1/8"X28	G1/8"X28	2	2	27	14	14
3A-04	G1/4"X19	G1/4"X19	4	4	28	19	19
3A-06	G3/8"X19	G3/8"X19	5	5	31	22	22
3A-08	G1/2"X14	G1/2"X14	6	6	35	27	27
3A-12	G3/4"X14	G3/4"X14	9	9	38	32	32
3A-16	G1"X11	G1"X11	10.5	10.5	40	41	41
3A-20	G1.1/4"X11	G1.1/4"X11	10	10	43	50	50
3A-24	G1.1/2"X11	G1.1/2"X11	11	11	46	55	55
3A-32	G2"X11	G2"X11	15	15	50	70	70

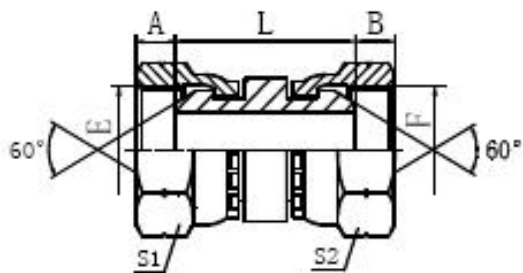

3B

英管内螺纹 60°外锥

BSPP FEMALE 60°CONE

代号 P/N	螺纹 Thread		尺寸 DIMENSIONS				
	E	F	A	B	L	S1	S2
3B-02	G1/8"X28	G1/8"X28	5.5	5.5	21	14	14
3B-02-04	G1/8"X28	G1/4"X19	5.5	5.5	23	14	19
3B-04	G1/4"X19	G1/4"X19	5.5	5.5	25	19	19
3B-04-06	G1/4"X19	G3/8"X19	5.5	6.3	26.5	19	22
3B-04-08	G1/4"X19	G1/2"X14	5.5	7.5	28.5	19	27
3B-06	G3/8"X19	G3/8"X19	6.3	6.3	29	22	22
3B-06-08	G3/8"X19	G1/2"X14	6.3	7.5	29.5	22	27
3B-08	G1/2"X14	G1/2"X14	7.5	7.5	32	27	27
3B-08-10	G1/2"X14	G5/8"X14	7.5	9.5	31.5	27	30
3B-08-12	G1/2"X14	G3/4"X14	7.5	10.9	32.5	27	32
3B-10	G5/8"X14	G5/8"X14	9.5	9.5	31.5	30	30
3B-10-12	G5/8"X14	G3/4"X14	9.5	10.9	33	30	32
3B-12	G3/4"X14	G3/4"X14	10.9	10.9	34	32	32
3B-12-16	G3/4"X14	G1"X11	10.9	11.7	35	32	41
3B-16	G1"X11	G1"X11	11.7	11.7	36.5	41	41
3B-20	G1.1/4"X11	G1.1/4"X11	11	11	41.5	50	50
3B-24	G1.1/2"X11	G1.1/2"X11	13	13	44	55	55
3B-32	G2"X11	G2"X11	16	16	48	70	70

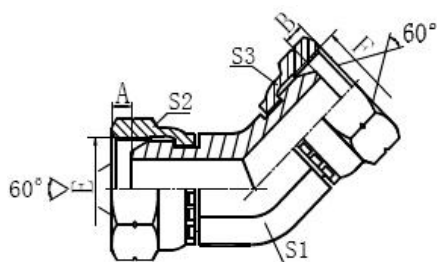

## 3B4

45° 英管内螺纹 60°外锥

45° BSPP FEMALE 60°CONE

代号 P/N	螺纹 Thread		尺寸 DIMENSIONS				
	E	F	A	B	S1	S2	S3
3B4-02	G1/8"X28	G1/8"X28	5.5	5.5	11	14	14
3B4-04	G1/4"X19	G1/4"X19	5.5	5.5	11	19	19
3B4-06	G3/8"X19	G3/8"X19	6.3	6.3	14	22	22
3B4-06-08	G3/8"X19	G1/2"X14	6.3	7.5	19	22	27
3B4-08	G1/2"X14	G1/2"X14	7.5	7.5	19	27	27
3B4-10	G5/8"X14	G5/8"X14	9.5	9.5	19	30	30
3B4-12	G3/4"X14	G3/4"X14	10.9	10.9	24	32	32
3B4-12-16	G3/4"X14	G1"X11	10.9	11.7	30	32	41
3B4-16	G1"X11	G1"X11	11.7	11.7	30	41	41
3B4-16-20	G1"X11	G1.1/4"X11	11.7	11	41	41	50
3B4-20	G1.1/4"X11	G1.1/4"X11	11	11	41	50	50
3B4-24	G1.1/2"X11	G1.1/2"X11	13	13	48	55	55

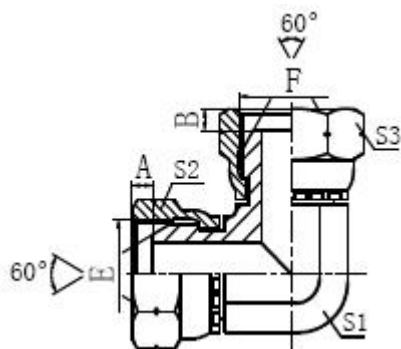

### 3B9

90° 英管内螺纹 60°外锥

90° BSPP FEMALE 60°CONE

代号 P/N	螺纹 Thread		尺寸 DIMENSIONS				
	E	F	A	B	S1	S2	S3
3B9-02	G1/8"X28	G1/8"X28	5.5	5.5	11	14	14
3B9-04	G1/4"X19	G1/4"X19	5.5	5.5	11	19	19
3B9-06	G3/8"X19	G3/8"X19	6.3	6.3	14	22	22
3B9-06-08	G3/8"X19	G1/2"X14	6.3	7.5	19	22	27
3B9-08	G1/2"X14	G1/2"X14	7.5	7.5	19	27	27
3B9-10	G5/8"X14	G5/8"X14	9.5	9.5	19	30	30
3B9-12	G3/4"X14	G3/4"X14	10.9	10.9	24	32	32
3B9-12-16	G3/4"X14	G1"X11	10.9	11.7	30	32	41
3B9-16	G1"X11	G1"X11	11.7	11.7	30	41	41
3B9-16-20	G1"X11	G1.1/4"X11	11.7	11	41	41	50
3B9-20	G1.1/4"X11	G1.1/4"X11	11	11	41	50	50
3B9-24	G1.1/2"X11	G1.1/2"X11	13	13	48	55	55
3B9-32	G2"X11	G2"X11	16	16	63	70	70



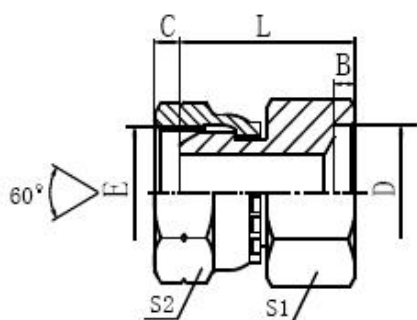

### 3BW-S/IN

英管内螺纹 60°外锥/英寸制焊接管

BSP FEMALE 60° CONE/INCH SOCKET-WELD TUBE

代号 P/N	螺纹 Thread		焊接管外径 D WELD TUBE O.D D	尺寸 DIMENSIONS				
	E	F		B	C	L	S1	S2
3BW-04S/IN	G1/4"X19		1/4"	3	5.5	20	12	19
3BW-06S/IN	G3/8"X19		3/8"	4	6.3	22	17	22
3BW-08S/IN	G1/2"X14		1/2"	4	7.5	24	19	27
3BW-10S/IN	G5/8"X14		5/8"	5	9.5	25.5	22	30
3BW-12S/IN	G3/4"X14		3/4"	5	10.9	31	27	32
3BW-16S/IN	G1"X11		1"	6	11.7	33	32	41
3BW-20S/IN	G1.1/4"X11		1.1/4"	6	11	37.5	41	50
3BW-24S/IN	G1.1/2"X11		1.1/2"	6	13	40	50	55

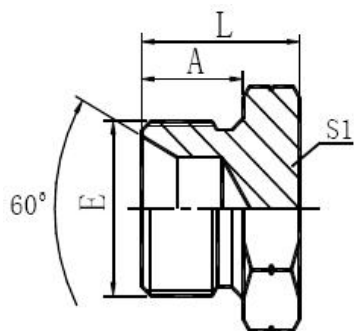

## 4B

英管外螺纹 60°内锥堵头

BSP MALE 60° SEAT PLUG

代号 P/N	螺纹 Thread		尺寸 DIMENSIONS			
	E	F	A	L	S1	
4B-02	G1/8"X28		10	16	14	
4B-04	G1/4"X19		12	18	19	
4B-06	G3/8"X19		13.5	21.5	22	
4B-08	G1/2"X14		16	26	27	
4B-10	G5/8"X14		17.5	27.5	30	
4B-12	G3/4"X14		18.5	29.5	32	
4B-16	G1"X11		20.5	34	41	
4B-20	G1.1/4"X11		20.5	37.5	50	
4B-24	G1.1/2"X11		23	40	55	
4B-32	G2"X11		25.5	43.5	70	

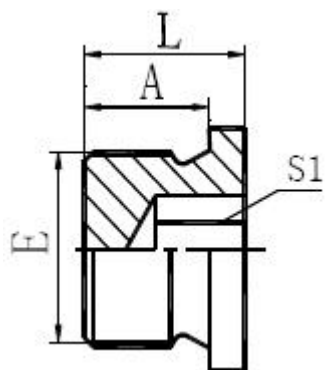

### 4BN

英管外螺纹内六角堵头

BSP MALE HOLLOW HEX PLUG

代号 P/N	螺纹 Thread		尺寸 DIMENSIONS			
	E	F	A	L	S1	
4BN-02	G1/8"X28		8	11	5	
4BN-04	G1/4"X19		12	15	6	
4BN-06	G3/8"X19		12	15	8	
4BN-08	G1/2"X14		14	18	10	
4BN-12	G3/4"X14		16	20	12	
4BN-16	G1"X11		16	21	17	

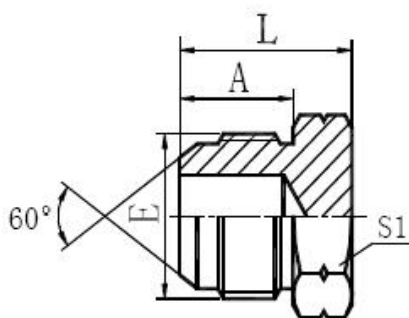

### 4S

英管外螺纹 60°外锥堵头

JIS GAS MALE 60° CONE PLUG

代号 P/N	螺纹 Thread		尺寸 DIMENSIONS			
	E	F	A	L	S1	
4S-04	G1/4"X19		14	20	19	
4S-06	G3/8"X19		16	24	22	
4S-08	G1/2"X14		19	29	27	
4S-12	G3/4"X14		21	32	32	
4S-16	G1"X11		23	36	41	

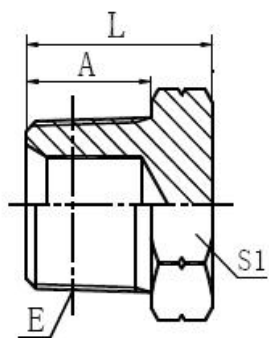

## 4T-SP

英锥管外螺纹堵头

BSPT MALE PLUG

代号 P/N	螺纹 Thread		尺寸 DIMENSIONS			
	E	F	A	L	S1	
4T-02SP	R1/8"X28		10	16	12	
4T-04SP	R1/4"X19		14.5	20	17	
4T-06SP	R3/8"X19		15	21	19	
4T-08SP	R1/2"X14		20	27	22	
4T-12SP	R3/4"X14		20	29	30	
4T-16SP	R1"X11		25.5	36.5	36	
4T-20SP	R1.1/4"X11		26.5	38.5	46	
4T-24SP	R1.1/2"X11		26.5	42	50	
4T-32SP	R2"X11		30	46	65	

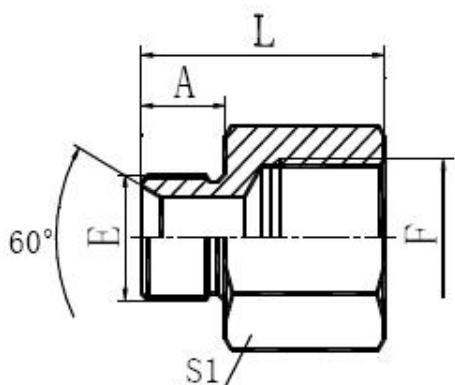

## 5B

英管外螺纹 60°内锥/英管内螺纹

BSP MALE 60° SEAT/BSP FEMALE

代号 P/N	螺纹 Thread		尺寸 DIMENSIONS			
	E	F	A	L	S1	
5B-02-04	G1/8"X28	G1/4"X19	11	32	19	
5B-02-06	G1/8"X28	G3/8"X19	11	35	22	
5B-04	G1/4"X19	G1/4"X19	12	33	19	
5B-04-02	G1/4"X19	G 1/8"X28	12	28.5	19	
5B-04-06	G1/4"X19	G3/8"X19	12	36	22	
5B-04-08	G1/4"X19	G1/2"X14	12	41	27	
5B-04-12	G1/4"X19	G3/4"X14	12	42	36	
5B-06	G3/8"X19	G3/8"X19	13.5	37.5	22	
5B-06-04	G3/8"X19	G1/4"X19	13.5	35	22	
5B-06-08	G3/8"X19	G1/2"X14	13.5	42.5	27	
5B-06-12	G3/8"X19	G3/4"X14	13.5	43.5	36	
5B-08-04	G1/2"X14	G1/4"X19	16	26	27	
5B-08	G1/2"X14	G1/2"X14	16	45	27	
5B-08-06	G1/2"X14	G3/8"X19	16	40	27	
5B-08-10	G1/2"X14	G5/8"X14	16	46	30	
5B-08-12	G1/2"X14	G3/4"X14	16	46	36	
5B-08-16	G1/2"X14	G1"X11	16	51	41	
5B-08-20	G1/2"X14	G1.1/4"X11	16	52	50	
5B-10-08	G5/8"X14	G1/2"X14	16	42	30	

5B-12	G3/4"X14	G3/4"X14	18.5	48	36	
5B-12-08	G3/4"X14	G1/2"X14	18.5	47.5	32	
5B-12-16	G3/4"X14	G1"X11	18.5	53.5	41	
5B-12-20	G3/4"X14	G1.1/4"X11	18.5	54.5	50	
5B-12-24	G3/4"X14	G1.1/2"X11	18.5	56.5	55	
5B-16	G1"X11	G1"X11	20.5	55.5	41	
5B-16-12	G1"X11	G3/4"X14	20.5	50.5	41	
5B-16-20	G1"X11	G1.1/4"X11	20.5	56.5	50	
5B-16-24	G1"X11	G1.1/2"X11	20.5	58.5	55	
5B-20-08	G1.1/4"X11	G1/2"X14	20.5	37.5	50	
5B-20-12	G1.1/4"X11	G3/4"X14	20.5	37.5	50	
5B-20-16	G1.1/4"X11	G1"X11	20.5	52	50	
5B-20	G1.1/4"X11	G1.1/4"X11	20.5	55	50	
5B-20-24	G1.1/4"X11	G1.1/2"X11	20.5	58.5	55	
5B-24	G1.1/2"X11	G1.1/2"X11	23	61	55	
5B-24-20	G1.1/2"X11	G1.1/4"X11	23	59	55	
5B-24-32	G1.1/2"X11	G2"X11	23	64	70	
5B-32-16	G2"X11	G1"X11	26	46.5	70	
5B-32-20	G2"X11	G1.1/4"X11	26	46.5	70	
5B-32-24	G2"X11	G1.1/2"X11	26	61	70	
5B-32	G2"X11	G2"X11	26	63	70	

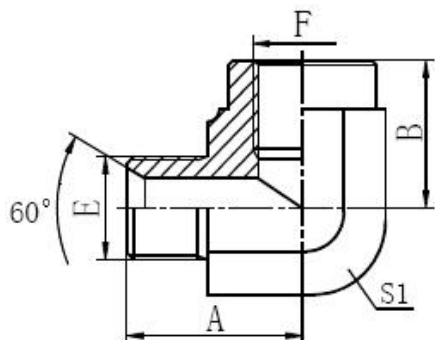

## 5B9

90°英管外螺纹 60°内锥/英管内螺纹

90° BSP MALE 60° SEAT/BSP FEMALE

代号 P/N	螺纹 Thread		尺寸 DIMENSIONS			
	E	F	A	B	S1	
5B9-02	G1/8"X28	G1/8"X28	22.5	20	16	
5B9-04	G1/4"X19	G1/4"X19	25.5	22	19	
5B9-06	G3/8"X19	G3/8"X19	30.5	26	24	
5B9-08	G1/2"X14	G1/2"X14	39	31	30	
5B9-12	G3/4"X14	G3/4"X14	43.5	37	33	
5B9-16	G1"X11	G1"X11	50.5	43	41	
5B9-20	G1.1/4"X11	G1.1/4"X11	55	46	50	

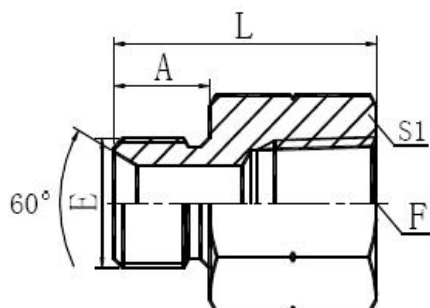

## 5BT

英管外螺纹 60°内锥/英锥管内螺纹

BSP MALE 60°SEAT/BSPT FEMALE

代号 P/N	螺纹 Thread		尺寸 DIMENSIONS			
	E	F	A	L	S1	
5BT-04-02	G1/4"X19	Rc1/8"X28	12	28	19	
5BT-04	G1/4"X19	Rc1/4"X19	12	33.5	19	
5BT-04-06	G1/4"X19	Rc3/8"X19	12	34	22	
5BT-04-08	G1/4"X19	Rc1/2"X14	12	41	27	
5BT-06	G3/8"X19	Rc3/8"X19	13.5	37.5	22	
5BT-06-04	G3/8"X19	Rc1/4"X19	13.5	35	22	
5BT-08	G1/2"X14	Rc1/2"X14	16	45	27	
5BT-08-06	G1/2"X14	Rc3/8"X19	16	39.5	27	
5BT-12	G3/4"X14	Rc3/4"X14	18.5	49	36	
5BT-12-08	G3/4"X14	Rc1/2"X14	18.5	47.5	32	
5BT-16	G1"X11	Rc1"X11	20.5	57	41	
5BT-20	G1.1/"X11	Rc1.1/4"X11	20.5	58.5	50	
5BT-24	G1.1/2"X11	Rc1.1/2"X11	23	61	55	



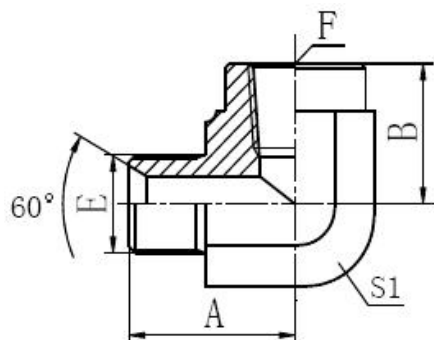

## 5BT9

90° 英管外螺纹 60°内锥/英锥管内螺纹

90° BSP MALE 60° SEAT/BSPT FEMALE

代号 P/N	螺纹 Thread		尺寸 DIMENSIONS			
	E	F	A	B	S1	
5BT9-04	G1/4"X19	Rc1/4"X19	27.5	25	19	
5BT9-04-02	G1/4"X19	Rc1/8"X28	25.5	20	16	
5BT9-04-06	G1/4"X19	Rc3/8"X19	30.5	27	24	
5BT9-06	G3/8"X19	Rc3/8"X19	32	27	24	
5BT9-06-04	G3/8"X19	Rc1/4"X19	28.5	25	19	
5BT9-06-08	G3/8"X19	Rc1/2"X14	36	31.5	30	
5BT9-08	G1/2"X14	Rc1/2"X14	38.5	31.5	30	
5BT9-08-06	G1/2"X14	Rc3/8"X19	35.5	27	24	
5BT9-08-12	G1/2"X14	Rc3/4"X14	41	37	33	
5BT9-12	G3/4"X14	Rc3/4"X14	43.5	37	33	
5BT9-12-08	G3/4"X14	Rc1/2"X14	41.5	31.5	30	
5BT9-12-16	G3/4"X14	Rc1" X11	48	43	41	
5BT9-16	G1"X11	Rc1" X11	50.5	43	41	
5BT9-16-12	G1"X11	Rc3/4"X14	46	37	33	

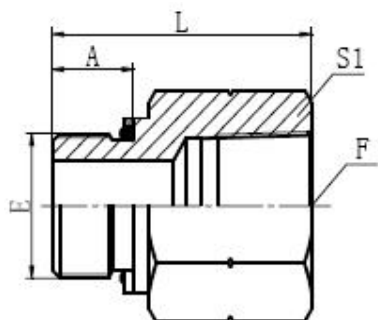

## 5GT

英管外螺纹 O 形圈/英锥管内螺纹

BSP MALE O-RING/BSPT FEMALE

代号 P/N	螺纹 Thread		O 形圈 O-RING		尺寸 DIMENSIONS		
	E	F	E 端		A	L	S1
5GT-02	G1/8"X28	Rc1/8"X28	7.65X1.78		9.5	26	14
5GT-04	G1/4"X19	Rc1/4"X19	10.77X2.62		10	32	19
5GT-06	G3/8"X19	Rc3/8"X19	13.94X2.62		11.5	37	22
5GT-08-06	G1/2"X14	Rc3/8"X19	17.12X2.62		14	38	27
5GT-08	G1/2"X14	Rc1/2"X14	17.12X2.62		14	46	27
5GT-12	G3/4"X14	Rc3/4"X14	23.47X2.62		15.5	48	36
5GT-16	G1"X11	Rc1"X11	29.74X3.53		18	52	41
5GT-20	G1.1/4"X11	Rc1.1/4"X11	37.69X3.53		20	57	50
5GT-24	G1.1/2"X11	Rc1.1/2"X11	44.04X3.53		21.5	59	55

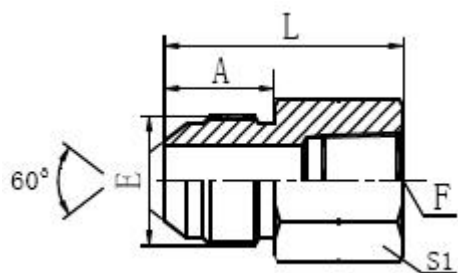

## 5ST

英管外螺纹 60°外锥/英锥管内螺纹

JIS GAS MALE 60°CONE/BSPT FEMALE

代号 P/N	螺纹 Thread		O 形圈 O-RING		尺寸 DIMENSIONS		
	E	F	E 端		A	L	S1
5ST-04	G1/4"X19	Rc1/4"X19			14	35.5	19
5ST-04-02	G1/4"X19	Rc1/8"X28			14	30	19
5ST-04-06	G1/4"X19	Rc3/8"X19			14	35	22
5ST-06	G3/8"X19	Rc3/8"X19			16	39.5	22
5ST-06-04	G3/8"X19	Rc1/4"X19			16	37.5	19
5ST-06-08	G3/8"X19	Rc1/2"X14			16	43.5	27
5ST-08	G1/2"X14	Rc1/2"X14			19	48	27
5ST-08-06	G1/2"X14	Rc3/8"X19			19	42.5	22
5ST-12	G3/4"X14	Rc3/4"X14			21	52	36
5ST-12-08	G3/4"X14	Rc1/2"X14			21	50	27
5ST-16	G1"X11	Rc1"X11			23	59.5	41

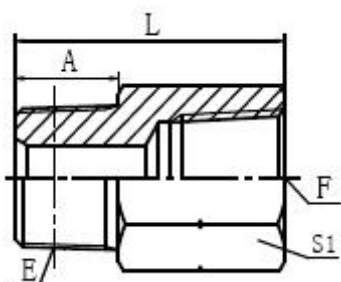

## 5T-SP

英锥管外螺纹/英锥管内螺纹

BSPT MALE/BSPT FEMALE

代号 P/N	螺纹 Thread		O 形圈 O-RING		尺寸 DIMENSIONS		
	E	F	E 端		A	L	S1
5T-02-0	R1/8"X28	Rc1/4"X1			11	32.5	19
5T-04-0	R1/4"X19	Rc1/8"X2			14.5	20.5	14
5T-04	R1/4"X19	Rc1/4"X1			14.5	36	19
5T-04-0	R1/4"X19	Rc3/8"X1			14.5	38	22
5T-06-0	R3/8"X19	Rc1/8"X2			15	23	19
5T-06-0	R3/8"X19	Rc1/4"X1			15	23	19
5T-06	R3/8"X19	Rc3/8"X1			15	38.5	22
5T-06-0	R3/8"X19	Rc1/2"X1			15	44	27
5T-08-0	R1/2"X14	Rc1/4"X1			20	30	24
5T-08-0	R1/2"X14	Rc3/8"X1			20	30	24
5T-08	R1/2"X14	Rc1/2"X1			20	49	27
5T-08-1	R1/2"X14	Rc3/4"X1			20	51	36
5T-12-0	R3/4"X14	Rc1/4"X1			20	31	30
5T-12-0	R3/4"X14	Rc3/8"X1			20	31	30
5T-12-0	R3/4"X14	Rc1/2"X1			20	31	30
5T-12	R3/4"X14	Rc3/4"X1			20	51	36
5T-12-1	R3/4"X14	Rc1"X11			20	56.5	41
5T-16-0	R1"X11	Rc1/4"X1			25.5	37	36
5T-16-0	R1"X11	Rc3/8"X1			25.5	37	36
5T-16-0	R1"X11	Rc1/2"X1			25.5	37	36
5T-16-1	R1"X11	Rc3/4"X1			25.5	37	36

5T-16	R1"X11	Rc1"X11			25.5	60	41
5T-16-2	R1"X11	Rc1.1/4"X1			25.5	64	50
5T-20-0	R1.1/4"X1	Rc1/4"X1			26.5	38	46
5T-20-0	R1.1/4"X1	Rc1/2"X1			26.5	36	46
5T-20-1	R1.1/4"X1	Rc3/4"X1			26.5	38	46
5T-20-1	R1.1/4"X1	Rc1"X11			26.5	38	46
5T-20	R1.1/4"X1	Rc1.1/4"X1			26.5	64.5	50
5T-24-1	R1.1/2"X1	Rc3/4"X1			26.5	41	50
5T-24-1	R1.1/2"X1	Rc1"X11			26.5	41	50
5T-24-2	R1.1/2"X1	Rc1.1/4"X1			26.5	41	50
5T-32-1	R2"X11	Rc1"X11			30	45	65
5T-32-2	R2"X11	Rc1.1/4"X1			30	45	65
5T-32-2	R2"X11	Rc1.1/2"X1			30	45	65

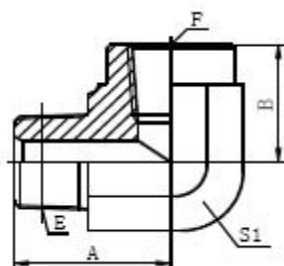

### 5T9-SP

90°英锥管外螺纹/英锥管内螺纹

90° BSPT MALE/BSPT FEMALE

代号 P/N	螺纹 Thread		O形圈 O-RING		尺寸 DIMENSIONS		
	E	F	E端		A	B	S1
5T9-02	R1/8"X	Rc1/8"X			24.5	23	16
5T9-04	R1/4"X	Rc1/4"X			28.5	25	19
5T9-06	R3/8"X	Rc3/8"X			33.5	25	24
5T9-08	R1/2"X	Rc1/2"X			40.8	31.5	30
5T9-12	R3/4"X	Rc3/4"X			47.5	37	33
5T9-16	R1"X1	Rc1"X			56.5	43	41
5T9-20	R1.1/4"	Rc1.1/4"			61	50	48
5T9-24	R1.1/2"	Rc1.1/2"			75	55	63

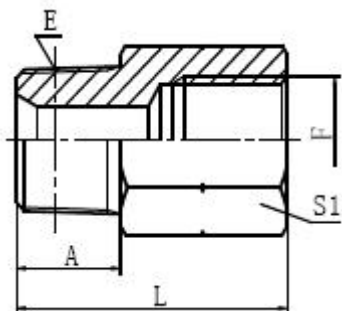

## 5TB-SP

英锥管外螺纹/英管内螺纹

BSPT MALE/BSP FEMALE

代号 P/N	螺纹 Thread		O 形圈 O-RING		尺寸 DIMENSIONS		
	E	F	E 端		A	L	S1
5TB-02-04	R1/8"X28	G1/4"X19			10	31.5	19
5TB-04SP	R1/4"X19	G1/4"X19			14.5	35	19
5TB-04-06	R1/4"X19	G3/8"X19			14.5	38.5	22
5TB-06SP	R3/8"X19	G3/8"X19			15	39	22
5TB-06-08	R3/8"X19	G1/2"X14			15	43	27
5TB-08SP	R1/2"X14	G1/2"X14			20	48	27
5TB-08-12	R1/2"X14	G3/4"X14			20	50	36
5TB-12SP	R3/4"X14	G3/4"X14			20	49	36
5TB-12-16	R3/4"X14	G1"X11			20	54.5	41
5TB-16SP	R1"X11	G1"X11			25.5	60	41
5TB-16-20	R1"X11	G1.1/4"X11			25.5	61.5	50
5TB-20SP	R1.1/4"X11	G1.1/4"X11			26.5	61.5	50
5TB-24SP	R1.1/2"X11	G1.1/2"X11			26.5	63	55

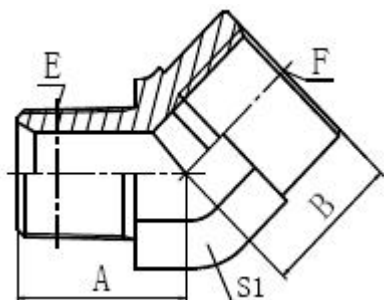

### 5TB4-SP

45° 英锥管外螺纹/英管内螺纹

45° BSPT MALE/BSP FEMALE

代号 P/N	螺纹 Thread		O 形圈 O-RING		尺寸 DIMENSIONS		
	E	F	E 端		A	B	S1
5TB4-02SP	R1/8"X28	G1/8"X28			18	20	16
5TB4-04SP	R1/4"X19	G1/4"X19			22	20	19
5TB4-06SP	R3/8"X19	G3/8"X19			25.5	23.5	24
5TB4-08SP	R1/2"X14	G1/2"X14			31.5	27.5	30
5TB4-12SP	R3/4"X14	G3/4"X14			32.5	31.5	33
5TB4-16SP	R1"X11	G1"X11			42	37.5	41

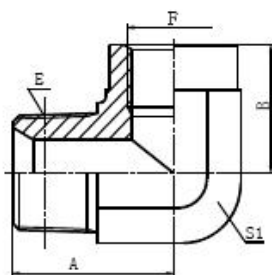

### 5TB9-SP

90° 英锥管外螺纹/英管内螺纹

90° BSPT MALE/BSP FEMALE

代号 P/N	螺纹 Thread		O 形圈 O-RING		尺寸 DIMENSIONS		
	E	F	E 端		A	B	S1
5TB9-0	R1/8"X28	G1/8"X28			24.5	20	16
5TB9-0	R1/4"X19	G1/4"X19			28.5	22	19
5TB9-0	R3/8"X19	G3/8"X19			33.5	26	24
5TB9-0	R1/2"X14	G1/2"X14			40.5	31	30
5TB9-1	R3/4"X14	G3/4"X14			47.5	37	33
5TB9-1	R1"X11	G1"X11			56.5	43	41

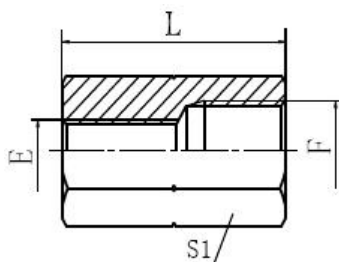

## 7B

英管内螺纹

BSP FEMALE

代号 P/N	螺纹 Thread		O形圈 O-RING		尺寸 DIMENSIONS		
	E	F	E端		L	S1	
7B-02	G1/8"X28	G1/8"X28			22	14	
7B-02-04	G1/8"X28	G1/4"X19			24	19	
7B-02-06	G1/8"X28	G3/8"X19			26	22	
7B-04	G1/4"X19	G1/4"X19			24	19	
7B-04-06	G1/4"X19	G3/8"X19			29	22	
7B-04-08	G1/4"X19	G1/2"X14			31	27	
7B-06	G3/8"X19	G3/8"X19			26	22	
7B-06-08	G3/8"X19	G1/2"X14			33	27	
7B-06-12	G3/8"X19	G3/4"X14			34	32	
7B-08	G1/2"X14	G1/2"X14			32	27	
7B-08-10	G1/2"X14	G5/8"X14			36	30	
7B-08-12	G1/2"X14	G3/4"X14			36	32	
7B-10	G5/8"X14	G5/8"X14			36	30	
7B-12	G3/4"X14	G3/4"X14			36	32	
7B-12-16	G3/4"X14	G1"X11			43	41	
7B-16	G1"X11	G1"X11			40	41	
7B-16-20	G1"X11	G1.1/4"X11			46	50	
7B-20	G1.1/4"X11	G1.1/4"X11			44	50	
7B-20-24	G1.1/4"X11	G1.1/2"X11			48	55	
7B-20-32	G1.1/4"X11	G2"X11			56	70	
7B-24	G1.1/2"X11	G1.1/2"X11			45	55	
7B-32	G2"X11	G2"X11			54	70	



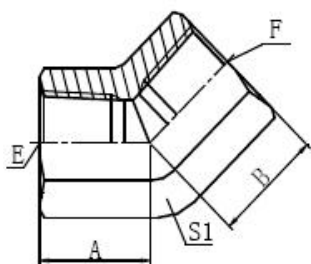

## 7B4

45° 英管内螺纹

45° BSP FEMALE

代号 P/N	螺纹 Thread		O形圈 O-RING		尺寸 DIMENSIONS		
	E	F	E 端		A	B	S1
7B4-02	G1/8"X28	G1/8"X28			18.5	18.5	16
7B4-04	G1/4"X19	G1/4"X19			20	20	19
7B4-06	G3/8"X19	G3/8"X19			25	25	24
7B4-08	G1/2"X14	G1/2"X14			27.5	27.5	27
7B4-12	G3/4"X14	G3/4"X14			31.5	31.5	33
7B4-16	G1"X11	G1"X11			37.5	37.5	41
7B4-20	G1.1/4"X11	G1.1/4"X11			48	48	50
7B4-24	G1.1/2"X11	G1.1/2"X11			53	53	60
7B4-32	G2"X11	G2"X11			62	62	70

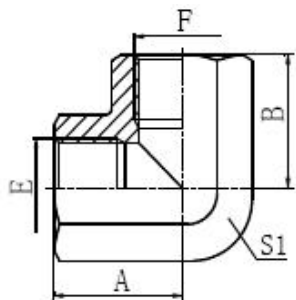

7B9

90° 英管内螺纹

90° BSP FEMALE

代号 P/N	螺纹 Thread		O 形圈 O-RING		尺寸 DIMENSIONS		
	E	F	E 端		A	B	S1
7B9-02	G1/8"X28	G1/8"X28			20	20	16
7B9-04	G1/4"X19	G1/4"X19			22.5	22.5	19
7B9-06	G3/8"X19	G3/8"X19			26	26	24
7B9-08	G1/2"X14	G1/2"X14			31	31	27
7B9-12	G3/4"X14	G3/4"X14			34	34	33
7B9-16	G1"X11	G1"X11			42	42	41
7B9-20	G1.1/4"X11	G1.1/4"X11			48	48	50
7B9-24	G1.1/2"X11	G1.1/2"X11			53	53	60
7B9-32	G2"X11	G2"X11			62	62	70

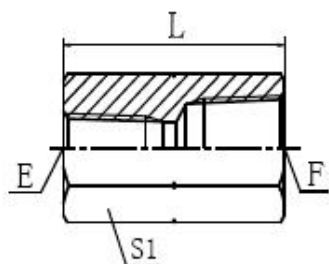

7T

英锥管内螺纹

BSPT FEMALE

代号 P/N	螺纹 Thread		O形圈 O-RING		尺寸 DIMENSIONS		
	E	F	E 端		L	S1	
7T-02	Rc1/8"X28	Rc1/8"X28			20	14	
7T-02-04	Rc1/8"X28	Rc1/4"X19			30	19	
7T-04	Rc1/4"X19	Rc1/4"X19			30	19	
7T-04-06	Rc1/4"X19	Rc3/8"X19			30	22	
7T-04-08	Rc1/4"X19	Rc1/2"X14			40	27	
7T-06	Rc3/8"X19	Rc3/8"X19			30	22	
7T-06-08	Rc3/8"X19	Rc1/2"X14			40	27	
7T-06-12	Rc3/8"X19	Rc3/4"X14			37	36	
7T-08	Rc1/2"X14	Rc1/2"X14			40	27	
7T-08-12	Rc1/2"X14	Rc3/4"X14			42	36	
7T-12	Rc3/4"X14	Rc3/4"X14			42	36	
7T-12-16	Rc3/4"X14	Rc1"X11			50	41	
7T-16	Rc1"X11	Rc1"X11			50	41	
7T-16-20	Rc1"X11	Rc1.1/4"X11			52	50	
7T-20	Rc1.1/4"X11	Rc1.1/4"X11			55	50	
7T-24	Rc1.1/2"X11	Rc1.1/2"X11			55	55	
7T-32	Rc2"X11	Rc2"X11			65	70	

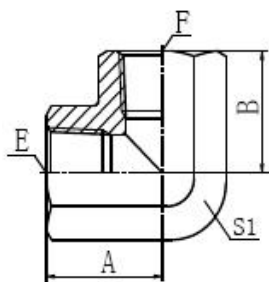

7T9

90°英锥管内螺纹

90°BSPT FEMALE

代号 P/N	螺纹 Thread		O形圈 O-RING		尺寸 DIMENSIONS		
	E	F	E 端		A	B	S1
7T9-02	Rc1/8"X28	Rc1/8"X28			20	20	16
7T9-02-08	Rc1/8"X28	Rc1/2"X14			25	31	27
7T9-04	Rc1/4"X19	Rc1/4"X19			22.5	22.5	19
7T9-06	Rc3/8"X19	Rc3/8"X19			26	26	24
7T9-08	Rc1/2"X14	Rc1/2"X14			31	31	27
7T9-12	Rc3/4"X14	Rc3/4"X14			34	34	33
7T9-16	Rc1"X11	Rc1"X11			42	42	41
7T9-20	Rc1.1/4"X11	Rc1.1/4"X11			48	48	50
7T9-24	Rc1.1/2"X11	Rc1.1/2"X11			53	53	60
7T9-32	Rc2"X11	Rc2"X11			62	62	70

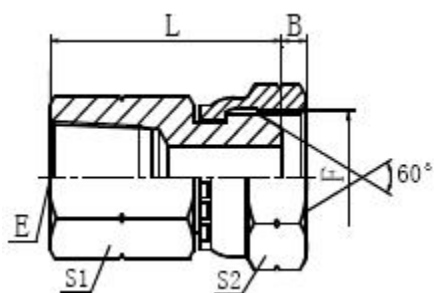

## 7TB-S

英锥管内螺纹/英管内螺纹 60°外锥

BSPT FEMALE/BSP FEMALE 60° CONE

代号 P/N	螺纹 Thread		尺寸 DIMENSIONS				
	E	F	B	L	S1	S2	
7TB-02-04	Rc1/8"X28	G1/4"X19	5.5	26.5	17	19	
7TB-04S	Rc1/4"X19	G1/4"X19	5.5	31	19	19	
7TB-04-06	Rc1/4"X19	G3/8"X19	6.3	31	19	22	
7TB-06S	Rc3/8"X19	G3/8"X19	6.3	35.2	22	22	
7TB-06-04	Rc3/8"X19	G1/4"X19	5.5	34	22	19	
7TB-06-08	Rc3/8"X19	G1/2"X14	7.5	37	22	27	
7TB-08-06	Rc1/2"X14	G3/8"X19	6.3	40.2	27	22	
7TB-08S	Rc1/2"X14	G1/2"X14	7.5	42	27	27	
7TB-08-12	Rc1/2"X14	G3/4"X14	10.9	43.1	27	32	
7TB-12S	Rc3/4"X14	G3/4"X14	10.9	45.1	36	32	
7TB-12-08	Rc3/4"X14	G1/2"X14	7.5	44	36	27	
7TB-12-16	Rc3/4"X14	G1"X11	11.7	46.3	36	41	
7TB-16-12	Rc1"X11	G3/4"X14	10.9	50.1	41	32	
7TB-16S	Rc1"X11	G1"X11	11.7	51.3	41	41	

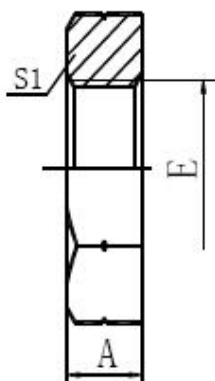

8B

英管螺纹锁母

BSP LOCKNUT

代号 P/N	螺纹 Thread		尺寸 DIMENSIONS				
	E	F	A	S1			
8B-02	G1/8"X28		5.5	14			
8B-04	G1/4"X19		6.5	19			
8B-06	G3/8"X19		7	22			
8B-08	G1/2"X14		9	27			
8B-10	G5/8"X14		9	30			
8B-12	G3/4"X14		10.5	32			
8B-16	G1"X11		10.5	41			
8B-20	G1.1/4"X11		10.5	50			
8B-24	G1.1/2"X11		10.5	55			
8B-32	G2"X11		10.5	70			

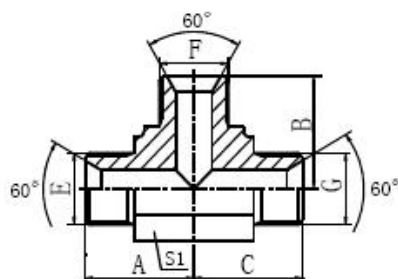

## AB

英管外螺纹 60°内锥

BSP MALE 60° SEAT

代号 P/N	螺纹 Thread			尺寸 DIMENSIONS			
	E	F	G	A	B	C	S1
AB-04	G1/4"X19	G1/4"X19	G1/4"X19	24.5	24.5	24.5	14
AB-06	G3/8"X19	G3/8"X19	G3/8"X19	27.5	27.5	27.5	16
AB-08	G1/2"X14	G1/2"X14	G1/2"X14	34.5	34.5	34.5	22
AB-10	G5/8"X14	G5/8"X14	G5/8"X14	35	35	35	22
AB-12	G3/4"X14	G3/4"X14	G3/4"X14	40	40	40	27
AB-16	G1"X11	G1"X11	G1"X11	46	46	46	33
AB-20	G1.1/4"X11	G1.1/4"X11	G1.1/4"X11	50.5	50.5	50.5	41
AB-24	G1.1/2"X11	G1.1/2"X11	G1.1/2"X11	57.5	57.5	57.5	48

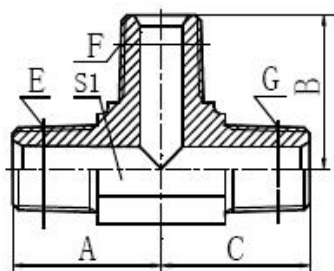

## AT-SP

英锥管外螺纹

BSPT MALE

代号 P/N	螺纹 Thread			尺寸 DIMENSIONS			
	E	F	G	A	B	C	S1
AT-02SP	R1/8"X28	R1/8"X28	R1/8"X28	21	21	21	11
AT-04SP	R1/4"X19	R1/4"X19	R1/4"X19	25.5	25.5	25.5	14
AT-06SP	R3/8"X19	R3/8"X19	R3/8"X19	28.5	28.5	28.5	16
AT-08SP	R1/2"X14	R1/2"X14	R1/2"X14	36	36	36	22
AT-12SP	R3/4"X14	R3/4"X14	R3/4"X14	43.5	43.5	43.5	27
AT-16SP	R1"X11	R1"X11	R1"X11	50	50	50	33
AT-20SP	R1.1/4"X11	R1.1/4"X11	R1.1/4"X11	57.5	57.5	57.5	41
AT-24SP	R1.1/2"X11	R1.1/2"X11	R1.1/2"X11	62.5	62.5	62.5	48
AT-32SP	R2"X11	R2"X11	R2"X11	75	75	75	63



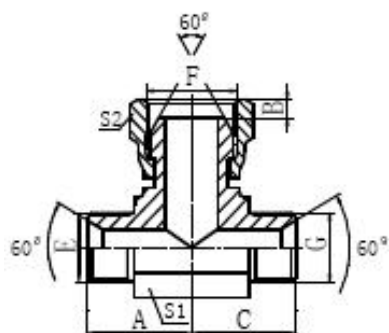

## BB

英管外螺纹

BSP MALE/BSP FEMALE/BSP MALE

代号 P/N	螺纹 Thread			尺寸 DIMENSIONS				
	E	F	G	A	B	C	S1	S2
BB-04	G1/4"X19	G1/4"X19	G1/4"X19	24.5	5.5	24.5	14	19
BB-06	G3/8"X19	G3/8"X19	G3/8"X19	27.5	6.3	27.5	16	22
BB-08	G1/2"X14	G1/2"X14	G1/2"X14	34.5	7.5	34.5	22	27
BB-12	G3/4"X14	G3/4"X14	G3/4"X14	40	10.9	40	27	32
BB-16	G1"X11	G1"X11	G1"X11	46	11.7	46	33	41
BB-20	G1.1/4"X11	G1.1/4"X11	G1.1/4"X11	50.5	11	50.5	41	50
BB-24	G1.1/2"X11	G1.1/2"X11	G1.1/2"X11	57.5	13	57.5	48	55

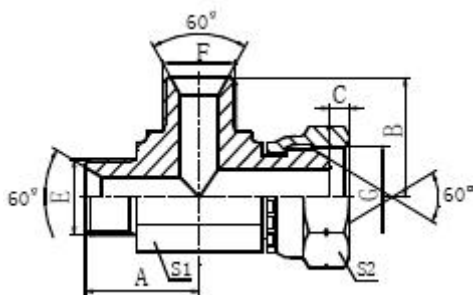

CB

英管外螺纹

BSP MALE/BSP MALE/BSP FEMALE

代号 P/N	螺纹 Thread			尺寸 DIMENSIONS				
	E	F	G	A	B	C	S1	S2
CB-04	G1/4"X19	G1/4"X19	G1/4"X19	25	25	5.5	14	19
CB-06	G3/8"X19	G3/8"X19	G3/8"X19	27.5	27.5	6.3	16	22
CB-08	G1/2"X14	G1/2"X14	G1/2"X14	34.5	34.5	7.5	22	27
CB-08-06-	G1/2"X14	G3/8"X19	G1/2"X14	34.5	31	7.5	22	27
CB-10	G5/8"X14	G5/8"X14	G5/8"X14	34.5	34.5	9.5	22	30
CB-12	G3/4"X14	G3/4"X14	G3/4"X14	40	40	10.9	27	32
CB-12-06-	G3/4"X14	G3/8"X19	G3/4"X14	40	34.5	10.9	27	32
CB-12-08-	G3/4"X14	G1/2"X14	G3/4"X14	40	37.5	10.9	27	32
CB-16	G1"X11	G1"X11	G1"X11	46	46	11.7	33	41
CB-20	G1.1/4"X11	G1.1/4"X11	G1.1/4"X11	50.5	50.5	11	41	50
CB-24	G1.1/2"X11	G1.1/2"X11	G1.1/2"X11	57.5	57.5	13	48	55

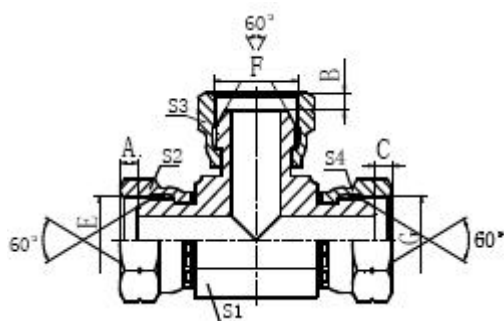

DB

英管内螺纹 60°外锥面

BSP FEMALE 60° CONE

代号 P/N	螺纹 Thread			尺寸 DIMENSIONS				
	E	F	G	A, C	B	S1	S2, S4	S3
DB-02	G1/8"X28	G1/8"X28	G1/8"X28	5.5	5.5	11	14	14
DB-04	G1/4"X19	G1/4"X19	G1/4"X19	5.5	5.5	11	19	19
DB-06	G3/8"X19	G3/8"X19	G3/8"X19	6.3	6.3	14	22	22
DB-08	G1/2"X14	G1/2"X14	G1/2"X14	7.5	7.5	19	27	27
DB-10	G5/8"X14	G5/8"X14	G5/8"X14	9.5	9.5	22	30	30
DB-12	G3/4"X14	G3/4"X14	G3/4"X14	10.9	10.9	24	32	32
DB-12-08-12	G3/4"X14	G1/2"X14	G3/4"X14	10.9	7.5	24	32	27
DB-16	G1"X11	G1"X11	G1"X11	11.7	11.7	30	41	41
DB-16-12-16	G1"X11	G3/4"X14	G1"X11	11.7	10.9	30	41	32
DB-20	G1.1/4"X11	G1.1/4"X11	G1.1/4"X11	11	11	36	50	50
DB-24	G1.1/2"X11	G1.1/2"X11	G1.1/2"X11	13	13	48	55	55
DB-32	G2"X11	G2"X11	G2"X11	16	16	55	70	70

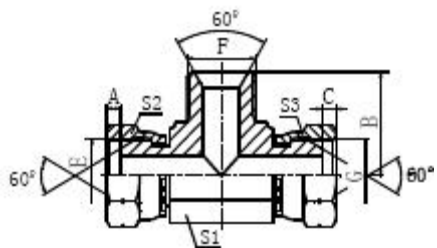

## EB

英管内螺纹/英管外螺纹/英管内螺纹

BSP FEMALE/BSP MALE/BSP FEMALE

代号 P/N	螺纹 Thread			尺寸 DIMENSIONS				
	E	F	G	A,C	B	S1	S2	S3
EB-04	G1/4"X19	G1/4"X19	G1/4"X19	5.5	24.5	14	19	19
EB-06	G3/8"X19	G3/8"X19	G3/8"X19	6.3	27.5	16	22	22
EB-08	G1/2"X14	G1/2"X14	G1/2"X14	7.5	34.5	22	27	27
EB-10	G5/8"X14	G5/8"X14	G5/8"X14	9.5	35	22	30	30
EB-12	G3/4"X14	G3/4"X14	G3/4"X14	10.9	40	27	32	32
EB-16	G1"X11	G1"X11	G1"X11	11.7	46	33	41	41
EB-20	G1.1/4"X11	G1.1/4"X11	G1.1/4"X11	11	50.5	41	50	50
EB-24	G1.1/2"X11	G1.1/2"X11	G1.1/2"X11	13	57.5	48	55	55

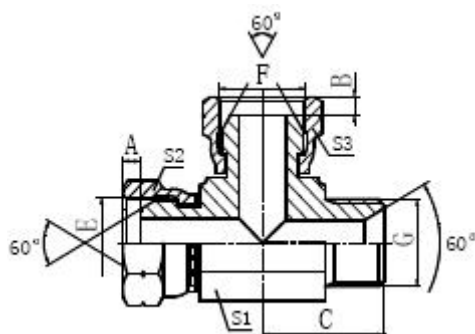

# FB

英管内螺纹/英管内螺纹/英管外螺纹

BSP FEMALE/BSP FEMALE/BSP MALE

代号 P/N	螺纹 Thread			尺寸 DIMENSIONS					
	E	F	G	A	B	C	S1	S2	S3
FB-04	G1/4"X19	G1/4"X19	G1/4"X19	5.5	5.5	24.5	14	19	19
FB-06	G3/8"X19	G3/8"X19	G3/8"X19	6.3	6.3	27.5	16	22	22
FB-08	G1/2"X14	G1/2"X14	G1/2"X14	7.5	7.5	34.5	22	27	27
FB-10	G5/8"X14	G5/8"X14	G5/8"X14	9.5	9.5	35	22	30	30
FB-12	G3/4"X14	G3/4"X14	G3/4"X14	10.9	10.9	40	27	32	32
FB-12-08-12	G3/4"X14	G1/2"X14	G3/4"X14	10.9	7.5	40	27	32	27
FB-16	G1"X11	G1"X11	G1"X11	11.7	11.7	46	33	41	41
FB-20	G1.1/4"X11	G1.1/4"X11	G1.1/4"X11	11	11	50.5	41	50	50
FB-24	G1.1/2"X11	G1.1/2"X11	G1.1/2"X11	13	13	57.5	48	55	55

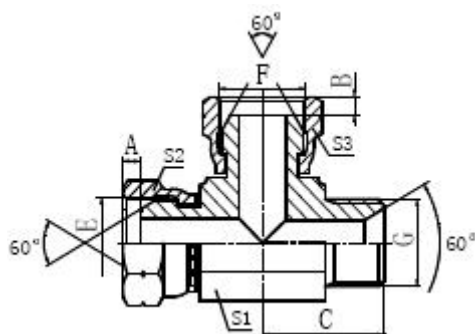

GB

英管内螺纹

BSP FEMALE

代号 P/N	螺纹 Thread			尺寸 DIMENSIONS					
	E	F	G	A	B	C	S1		
GB-02	G1/8"X28	G1/8"X28	G1/8"X28	20	20	20	16		
GB-04	G1/4"X19	G1/4"X19	G1/4"X19	22.5	22.5	22.5	19		
GB-06	G3/8"X19	G3/8"X19	G3/8"X19	26	26	26	24		
GB-08	G1/2"X14	G1/2"X14	G1/2"X14	31	31	31	27		
GB-12	G3/4"X14	G3/4"X14	G3/4"X14	34	34	34	33		
GB-16	G1"X11	G1"X11	G1"X11	42	42	42	41		
GB-20	G1.1/4"X11	G1.1/4"X11	G1.1/4"X11	48	48	48	50		
GB-24	G1.1/2"X11	G1.1/2"X11	G1.1/2"X11	53	53	53	60		
GB-32	G2"X11	G2"X11	G2"X11	62	62	62	70		

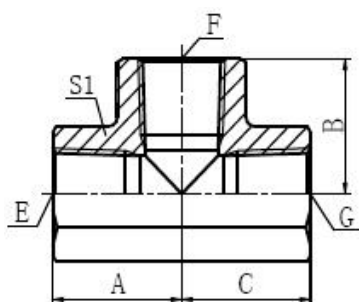

GT

英锥管内螺纹

BSPT FEMALE

代号 P/N	螺纹 Thread			尺寸 DIMENSIONS					
	E	F	G	A	B	C	S1		
GT-02	Rc1/8"X28	Rc1/8"X28	Rc1/8"X28	20	20	20	16		
GT-04	Rc1/4"X19	Rc1/4"X19	Rc1/4"X19	22.5	22.5	22.5	19		
GT-06	Rc3/8"X19	Rc3/8"X19	Rc3/8"X19	26	26	26	24		
GT-08	Rc1/2"X14	Rc1/2"X14	Rc1/2"X14	31	31	31	27		
GT-12	Rc3/4"X14	Rc3/4"X14	Rc3/4"X14	34	34	34	33		
GT-16	Rc1"X11	Rc1"X11	Rc1"X11	42	42	42	41		
GT-20	Rc1.1/4"X11	Rc1.1/4"X11	Rc1.1/4"X11	48	48	48	50		
GT-24	Rc1.1/2"X11	Rc1.1/2"X11	Rc1.1/2"X11	53	53	53	60		
GT-32	Rc2"X11	Rc2"X11	Rc2"X11	62	62	62	70		

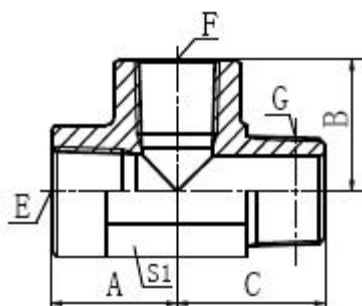

## HT

英锥管内螺纹/英锥管内螺纹/英锥管外螺纹

BSPT FEMALE/BSPT FEMALE/BSPT MALE

代号 P/N	螺纹 Thread			尺寸 DIMENSIONS					
	E	F	G	A	B	C	S1		
HT-04	Rc1/4"X19	Rc1/4"X19	R1/4"X19	25	25	28	19		
HT-06	Rc3/8"X19	Rc3/8"X19	R3/8"X19	27	27	33.5	24		
HT-08	Rc1/2"X14	Rc1/2"X14	R1/2"X14	31.2	31.2	40.8	30		
HT-12	Rc3/4"X14	Rc3/4"X14	R3/4"X14	37	37	47.5	33		

**NOTES**

The drawings in this catalogue are for reference only, and their dimensions and proportions may be a little different from those of the real products.

Products included in this catalogue don't refer to all, so if customers are interested in other products, please don't hesitate to contact our company for further information.

Our company has made much effort to record the correct data in this publication. However, in order to promote our products, we may make some changes of their size or description, which haven't been shown yet. We reserve the rights for explanation, but sorry for no further notice to customer the change of products' design, description or even stop of some products' manufacture in future.